

DISCLAIMER

THIS DRAWING REPRESENTS VISUAL CONCEPTS AND SUGGESTIONS FOR CONSTRUCTION ONLY. THE DESIGNER IS UNQUALIFIED TO DETERMINE THE ELECTRICAL OR STRUCTURAL APPROPRIATENESS OF THIS DESIGN AND WILL NOT ASSUME RESPONSIBILITY FOR IMPROPER ENGINEERING, CONSTRUCTION, OR USE.

REVISIONS

#	REVISION	DATE
5	REVISION	12/07/2022
4	REVISION	12/05/2022
3	REVISION	12/02/2022
2	FINAL	11/18/2022
1	PRELIM.	10/20/2022

NOTES

- WALLS A, B, F, G, H, AND J MOVE A VISTA DURING SHOW TO STORAGE POSITIONS (REFER TO PLATE XX)
- CEILING MUST BE SELF-SUPPORTED
- ACTOR TO CLIMB THROUGH UPSTAGE WINDOW ON WALL G
- WALLS A AND B BUILT CONNECTED TO EACH OTHER, REFERRED TO AS "UNIT A/B"
- PLEASE NOTE: THE SCRIPT CALLS FOR AN ACTOR TO BEAT A BASEBALL BAT A REPEATED NUMBER OF TIMES AGAINST THE FLOOR AND WALLS OF THE SET.

QUEENS

WRITTEN BY MARTYNA MAJOK

DIRECTED BY TEA ALAGIC
 SCENIC DESIGN BY TAYLOR FRIEL
 TECHNICAL DIRECTION BY JON ALLAIRE
 ASSISTANT TECHNICAL DIRECTOR:
 AARON MINERBROOK
 ASSISTANT SCENIC DESIGNERS:
 VINITA GATNE & BRIAN BERNHARD

VENUE:
 THE ATLAS ROOM
 111 SECOND AVENUE
 NEW YORK, NEW YORK 10003

COMPOSITE GROUND PLAN

DATE:
 07 DECEMBER 2022

SCALE:
 1/2" = 1' - 0"

PLATE

01
 OF 09

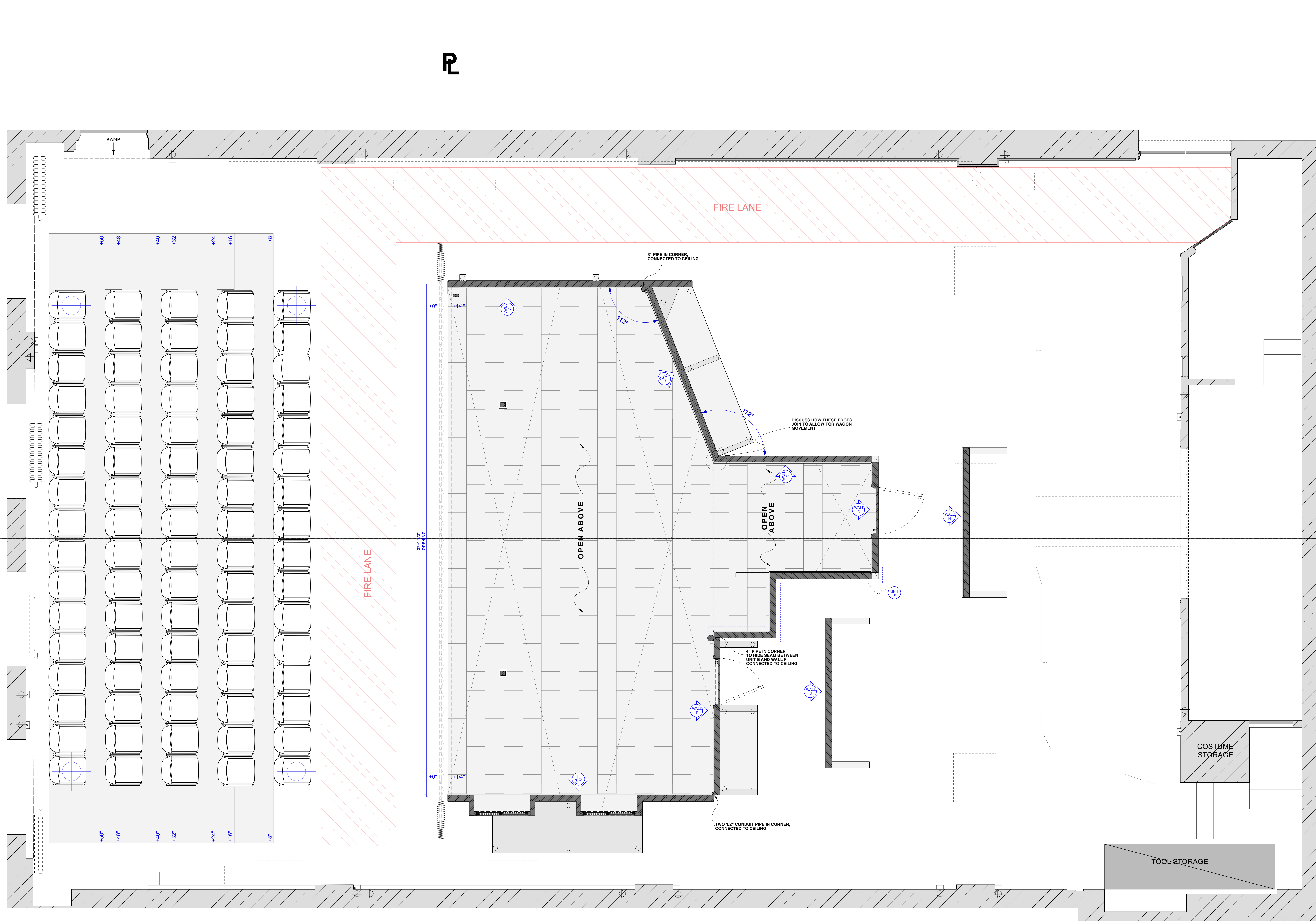

DISCLAIMER

THIS DRAWING REPRESENTS VISUAL CONCEPTS AND SUGGESTIONS FOR CONSTRUCTION ONLY. THE DESIGNER IS UNQUALIFIED TO DETERMINE THE ELECTRICAL OR STRUCTURAL APPROPRIATENESS OF THIS DESIGN AND WILL NOT ASSUME RESPONSIBILITY FOR IMPROPER ENGINEERING, CONSTRUCTION, OR USE.

REVISIONS

#	REVISION	DATE
5	REVISION	12/07/2022
4	REVISION	12/05/2022
3	REVISION	12/02/2022
2	FINAL	11/18/2022
1	PRELIM.	10/20/2022

NOTES

- WALLS A, B, F, G, H, AND J MOVE A VISTA DURING SHOW TO STORAGE POSITIONS (REFER TO PLATE XX)
- CEILING MUST BE SELF-SUPPORTED
- ACTOR TO CLIMB THROUGH UPSTAGE WINDOW ON WALL G
- WALLS A AND B BUILT CONNECTED TO EACH OTHER, REFERRED TO AS "UNIT A/B"
- PLEASE NOTE: THE SCRIPT CALLS FOR AN ACTOR TO BEAT A BASEBALL BAT A REPEATED NUMBER OF TIMES AGAINST THE FLOOR AND WALLS OF THE SET.

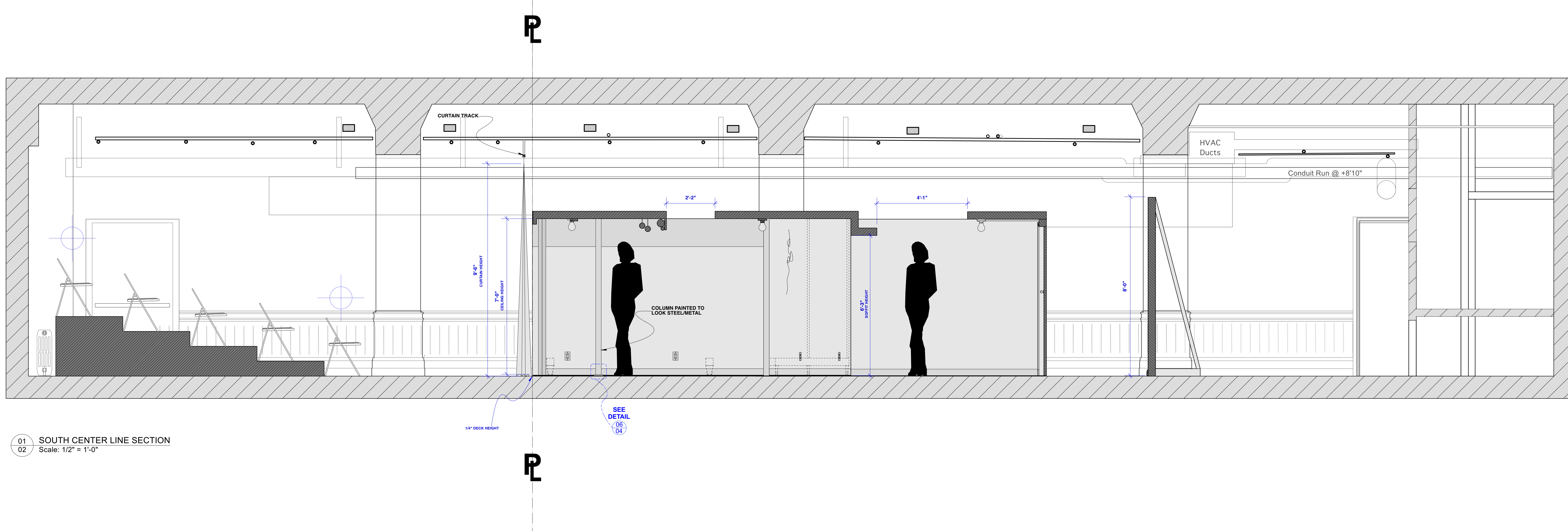

01 SOUTH CENTER LINE SECTION
Scale: 1/2" = 1'-0"

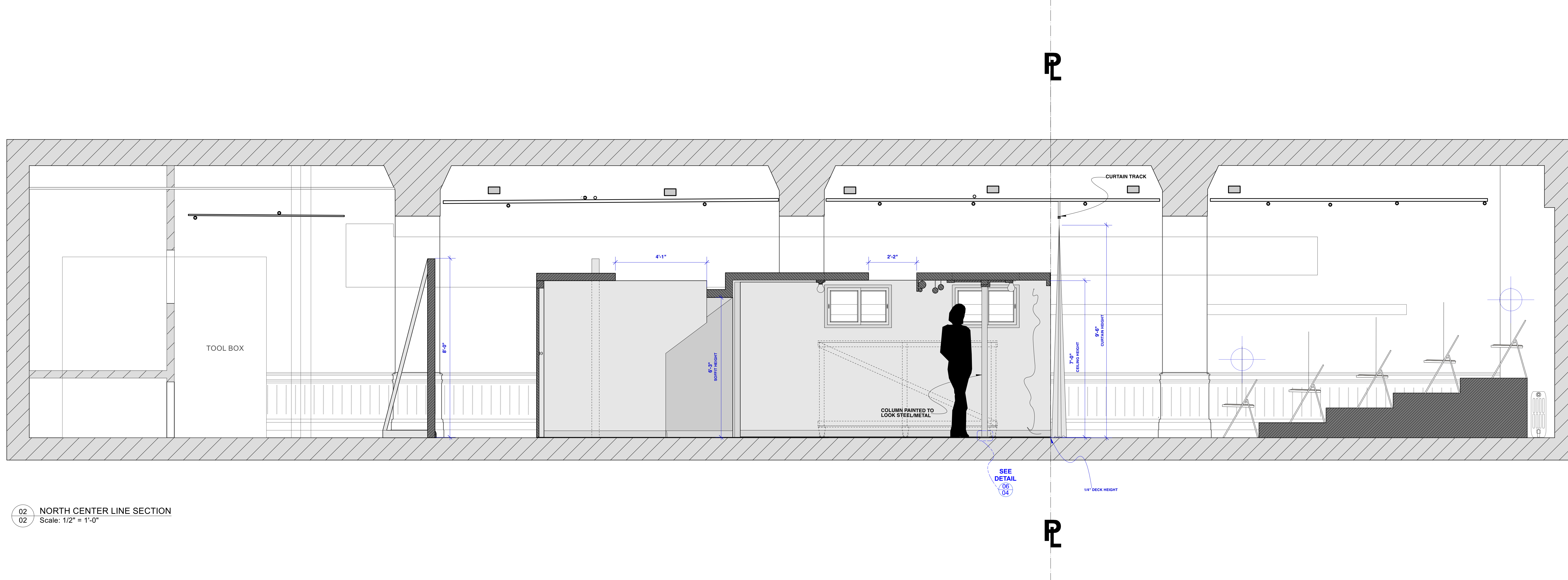

02 NORTH CENTER LINE SECTION
Scale: 1/2" = 1'-0"

QUEENS

WRITTEN BY MARTYNA MAJOK

DIRECTED BY TEA ALAGIC
SCENIC DESIGN BY TAYLOR FRIEL
TECHNICAL DIRECTION BY JON ALLAIRE
ASSISTANT TECHNICAL DIRECTOR:
AARON MINERBROOK
ASSISTANT SCENIC DESIGNERS:
VINITA GATNE & BRIAN BERNHARD

VENUE:
THE ATLAS ROOM
111 SECOND AVENUE
NEW YORK, NEW YORK 10003

NORTH & SOUTH CL SECTIONS

DATE:
07 DECEMBER 2022

SCALE:
1/2" = 1' - 0"

PLATE
02
OF 09

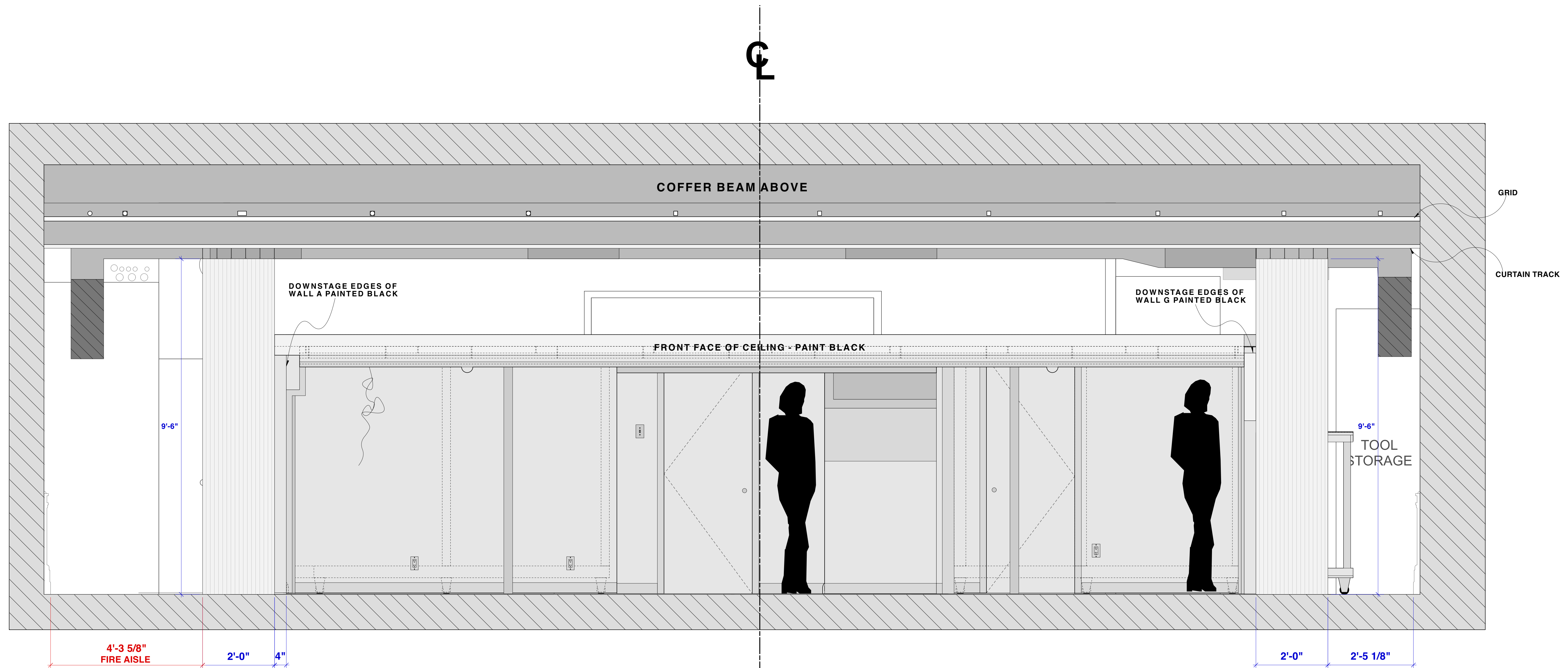

1 COMPOSITE FRONT ELEVATION - CURTAINS OPEN
Scale: 3/4" = 1'-0"

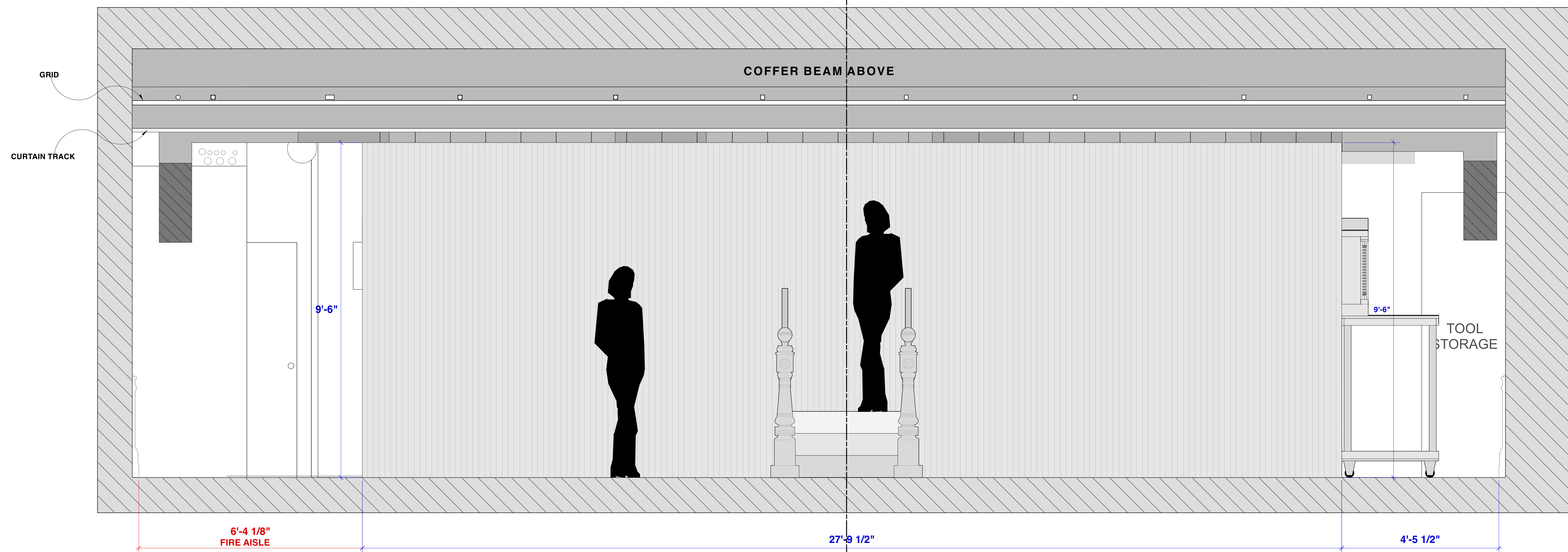

2 COMPOSITE FRONT ELEVATION - CURTAINS CLOSED
Scale: 3/4" = 1'-0"

DISCLAIMER

THIS DRAWING REPRESENTS VISUAL CONCEPTS AND SUGGESTIONS FOR CONSTRUCTION ONLY. THE DESIGNER IS UNQUALIFIED TO DETERMINE THE ELECTRICAL OR STRUCTURAL APPROPRIATENESS OF THIS DESIGN AND WILL NOT ASSUME RESPONSIBILITY FOR IMPROPER ENGINEERING, CONSTRUCTION, OR USE.

REVISIONS

#	REVISION	DATE
5	REVISION	12/07/2022
4	REVISION	12/05/2022
3	REVISION	12/02/2022
2	FINAL	11/18/2022
1	PRELIM.	10/20/2022

NOTES

- WALLS A, B, F, G, H, AND J MOVE A VISTA DURING SHOW TO STORAGE POSITIONS (REFER TO PLATE XX)
- CEILING MUST BE SELF-SUPPORTED
- ACTOR TO CLIMB THROUGH UPSTAGE WINDOW ON WALL G
- WALLS A AND B BUILT CONNECTED TO EACH OTHER, REFERRED TO AS "UNIT A/B"
- PLEASE NOTE: THE SCRIPT CALLS FOR AN ACTOR TO BEAT A BASEBALL BAT A REPEATED NUMBER OF TIMES AGAINST THE FLOOR AND WALLS OF THE SET.

QUEENS

WRITTEN BY MARTYNA MAJOK

DIRECTED BY TEA ALAGIC

SCENIC DESIGN BY TAYLOR FRIEL

TECHNICAL DIRECTION BY JON ALLAIRE

ASSISTANT TECHNICAL DIRECTOR: AARON MINERBROOK

ASSISTANT SCENIC DESIGNERS: VINITA GATNE & BRIAN BERNHARD

VENUE:
THE ATLAS ROOM
111 SECOND AVENUE
NEW YORK, NEW YORK 10003

COMPOSITE FRONT ELEVATIONS

DATE:
07 DECEMBER 2022

SCALE:
3/4" = 1' - 0"

PLATE

03

OF 09

DISCLAIMER

THIS DRAWING REPRESENTS VISUAL CONCEPTS AND SUGGESTIONS FOR CONSTRUCTION ONLY. THE DESIGNER IS UNQUALIFIED TO DETERMINE THE ELECTRICAL OR STRUCTURAL APPROPRIATENESS OF THIS DESIGN AND WILL NOT ASSUME RESPONSIBILITY FOR IMPROPER ENGINEERING, CONSTRUCTION, OR USE.

REVISIONS

#	REVISION	DATE
5	REVISION	12/07/2022
4	REVISION	12/05/2022
3	REVISION	12/02/2022
2	FINAL	11/18/2022
1	PRELIM.	10/20/2022

NOTES

- PLEASE NOTE: THE SCRIPT CALLS FOR AN ACTOR TO BEAT A BASEBALL BAT A REPEATED NUMBER OF TIMES AGAINST THE FLOOR AND WALLS OF THE SET.
- SEE PLATE 08 FOR PAINT DETAILS

QUEENS

WRITTEN BY MARTYNA MAJOK

DIRECTED BY TEA ALAGIC
SCENIC DESIGN BY TAYLOR FRIEL
TECHNICAL DIRECTION BY JON ALLAIRE
ASSISTANT TECHNICAL DIRECTOR:
AARON MINERBROOK
ASSISTANT SCENIC DESIGNERS:
VINITA GATNE & BRIAN BERNHARD

VENUE:
THE ATLAS ROOM
111 SECOND AVENUE
NEW YORK, NEW YORK 10003

DECK PLAN

DATE:
07 DECEMBER 2022

SCALE:
AS NOTED

PLATE

04
OF 09

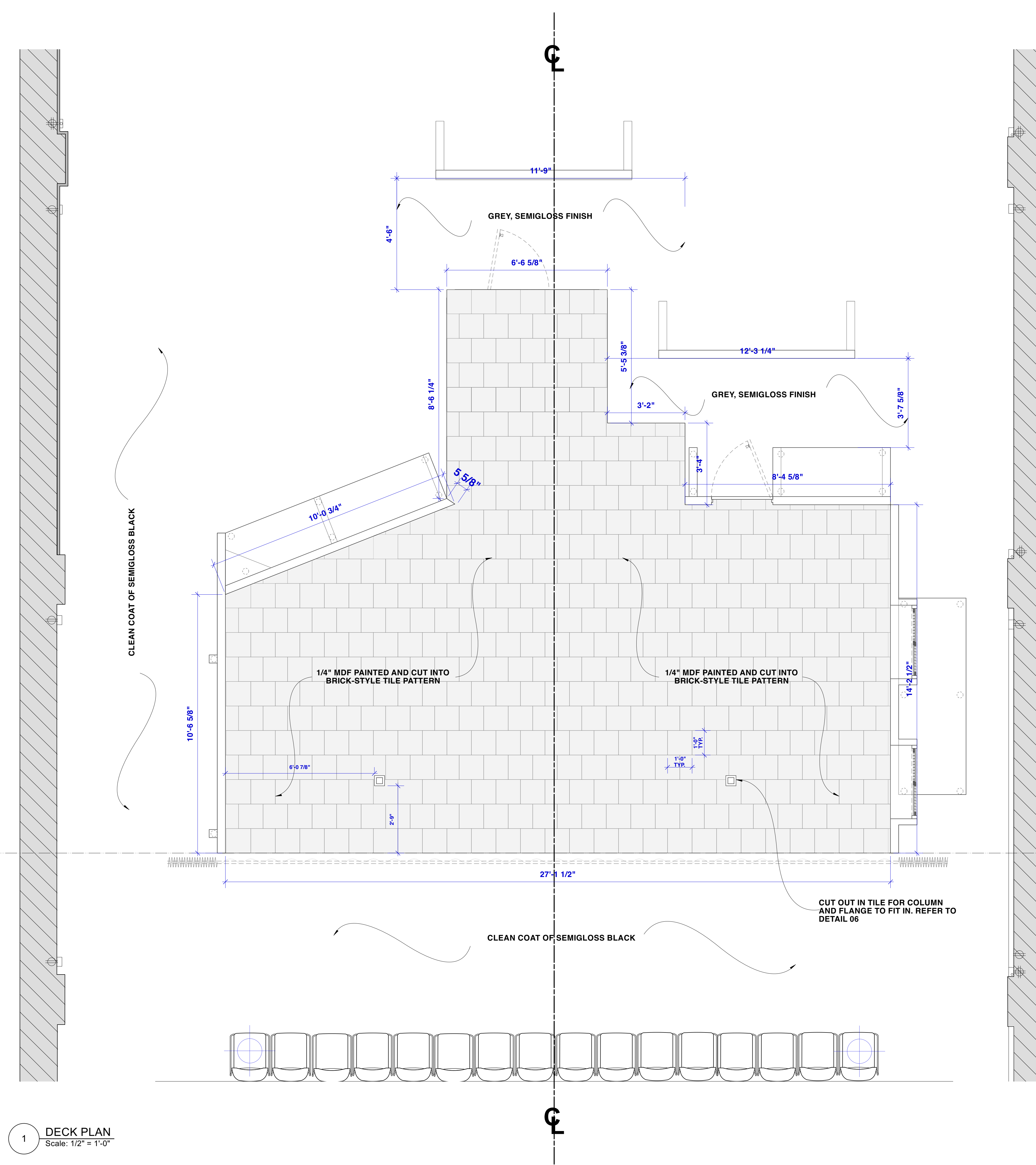

1 DECK PLAN
Scale: 1/2" = 1'-0"



05 DECK TILE RESEARCH
NOT TO SCALE

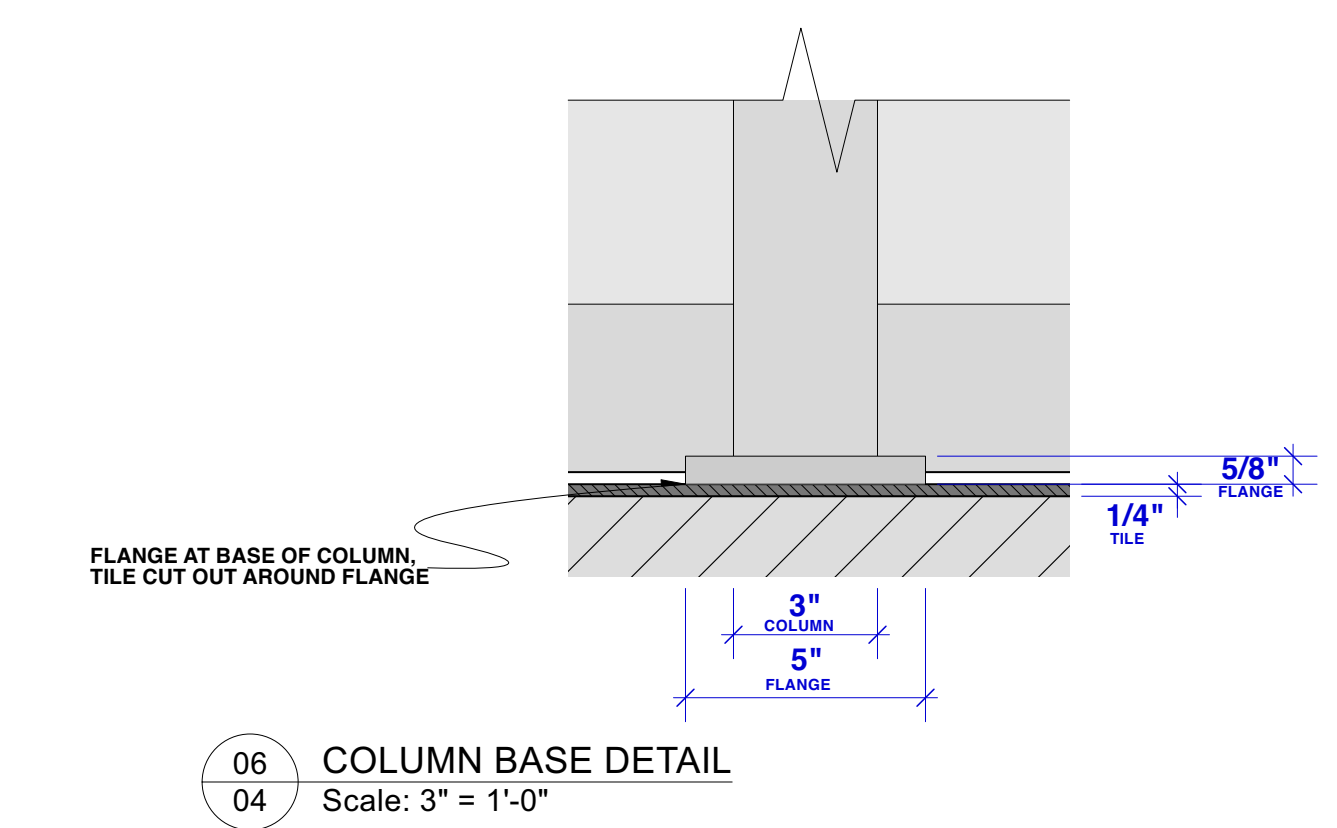

06 COLUMN BASE DETAIL
Scale: 3" = 1'-0"

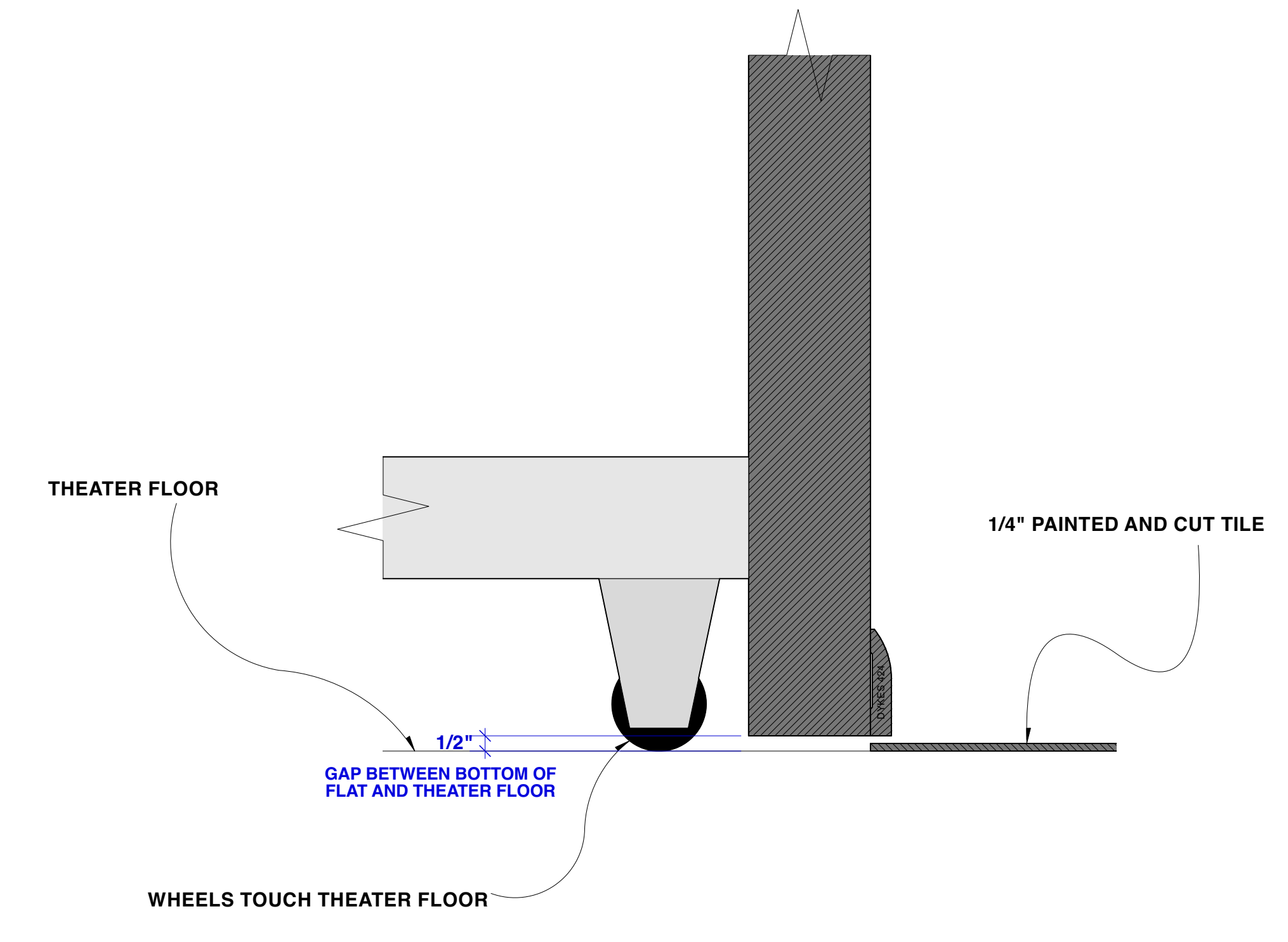

2 WAGON WALLS F, G, AND UNIT A/B DECK DETAIL
Scale: 3" = 1'-0"

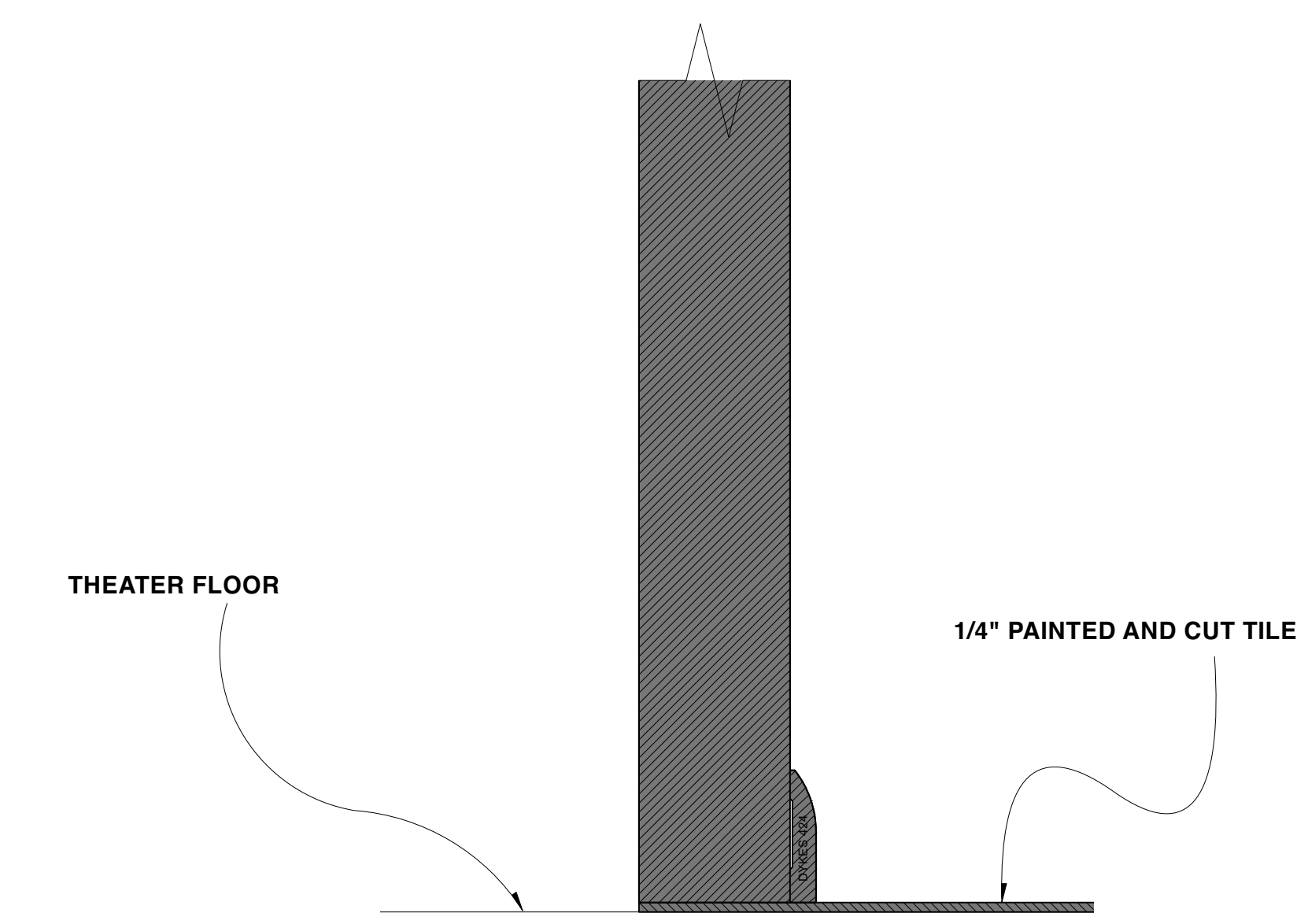

3 STATIONARY WALLS C, D, AND UNIT E DECK DETAIL
Scale: 3" = 1'-0"

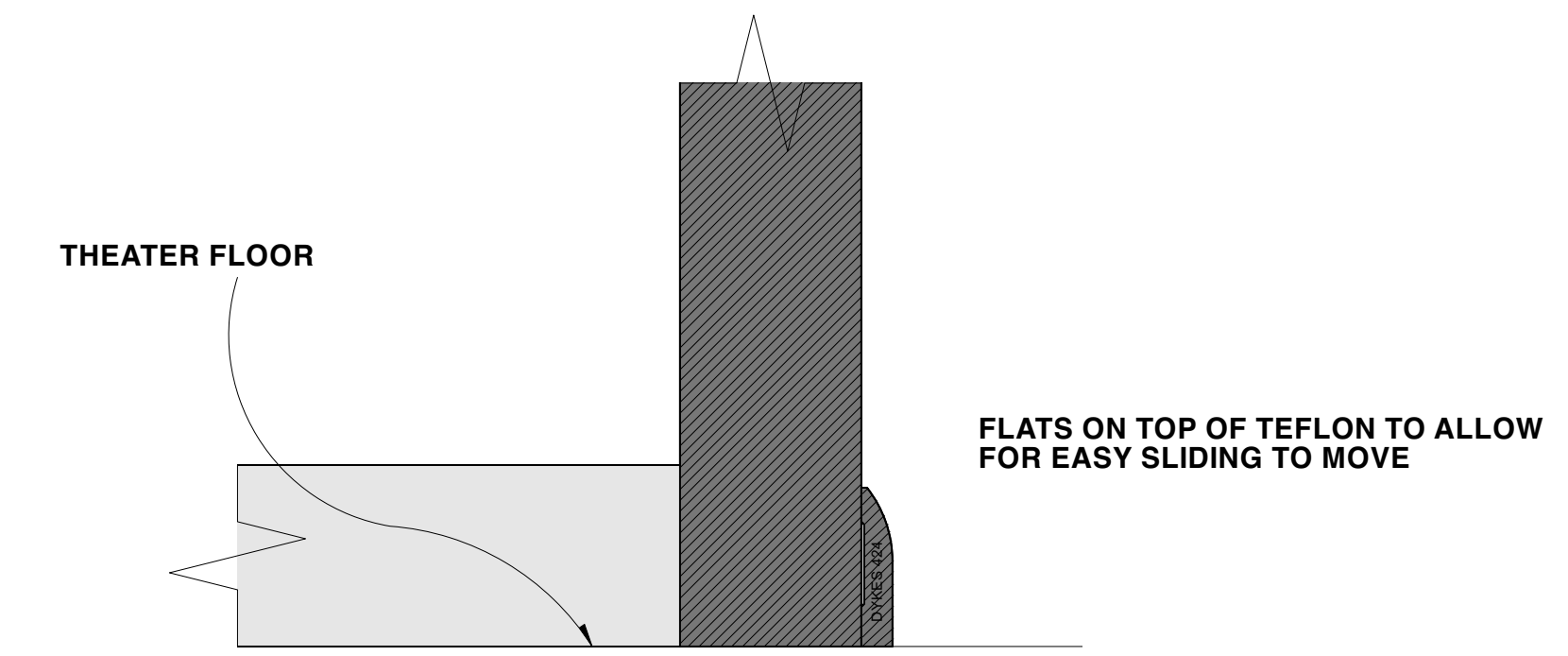

6 WALLS H AND J FLOOR DETAIL
Scale: 3" = 1'-0"

DISCLAIMER

THIS DRAWING REPRESENTS VISUAL CONCEPTS AND SUGGESTIONS FOR CONSTRUCTION ONLY. THE DESIGNER IS UNQUALIFIED TO DETERMINE THE ELECTRICAL OR STRUCTURAL APPROPRIATENESS OF THIS DESIGN AND WILL NOT ASSUME RESPONSIBILITY FOR IMPROPER ENGINEERING, CONSTRUCTION, OR USE.

REVISIONS

#	REVISION	DATE
5	REVISION	12/07/2022
4	REVISION	12/05/2022
3	REVISION	12/02/2022
2	FINAL	11/18/2022
1	PRELIM.	10/20/2022

NOTES

- CEILING MUST BE SELF-SUPPORTED
- CEILING SURFACE TO RECEIVE SAME PAINT AND TEXTURE TREATMENT AS WALLS A THROUGH G
- 4 TOTAL CEILING PRACTICALS. EACH SHOULD BE CONNECTED TO VISIBLE ELECTRICAL CABLING AND BOX(ES). DISCUSS WITH LX
- PIPES TO BE GRAY, BLACK, OR EGGSHELL. DISCUSS AS-IS COLORS OF AVAILABLE PIPE
- DISCUSS LEAVING SEAMS IN CEILING
- SEE PLATE 08 FOR PAINT DETAILS

QUEENS

WRITTEN BY MARTYNA MAJOK

DIRECTED BY TEA ALAGIC

SCENIC DESIGN BY TAYLOR FRIEL

TECHNICAL DIRECTION BY JON ALLAIRE

ASSISTANT TECHNICAL DIRECTOR: AARON MINERBROOK

ASSISTANT SCENIC DESIGNERS: VINITA GATHE & BRIAN BERNHARD

VENUE:

THE ATLAS ROOM
111 SECOND AVENUE
NEW YORK, NEW YORK 10003

REFLECTED CEILING PLAN

DATE:
07 DECEMBER 2022

SCALE:
AS NOTED

PLATE

05

OF 09

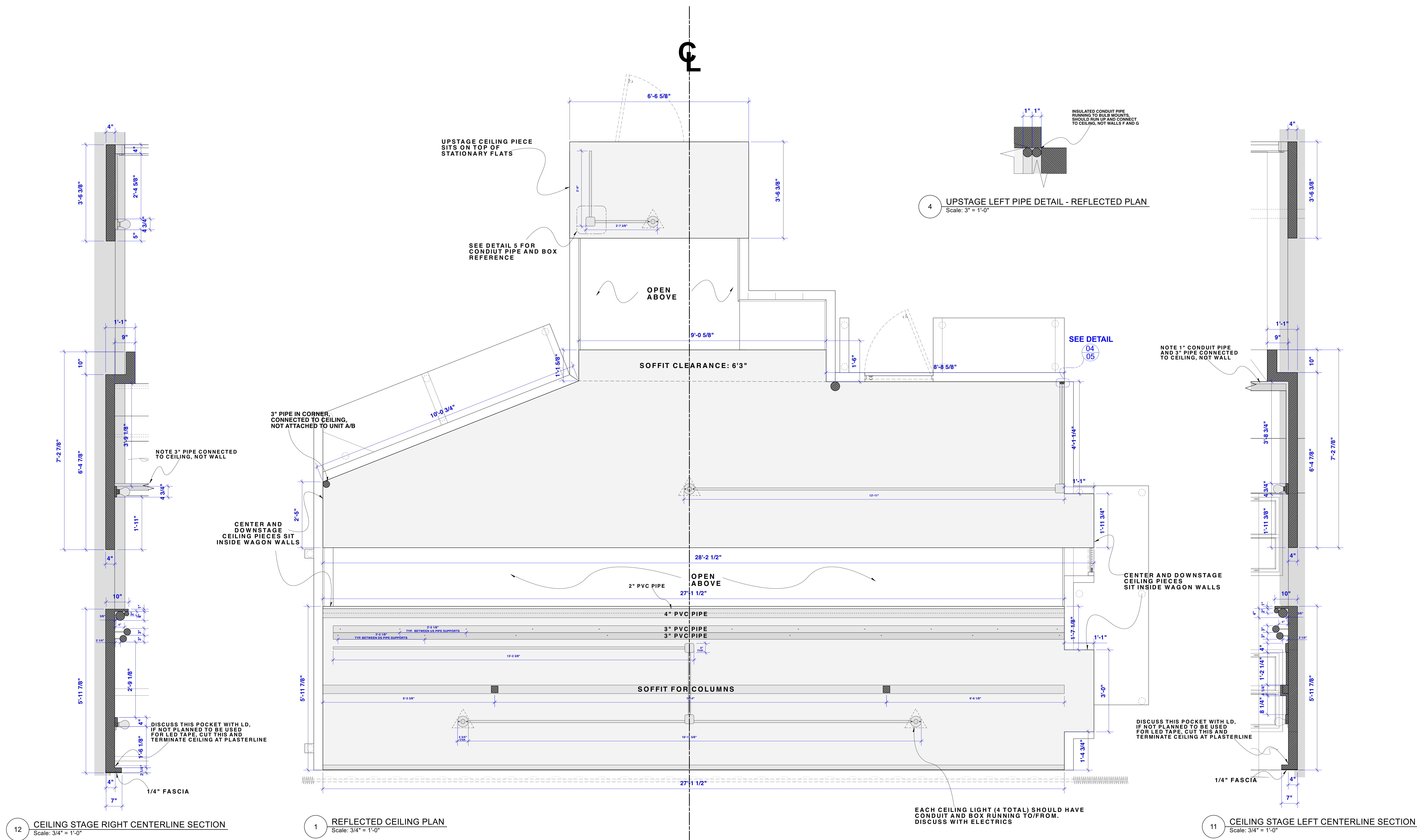

12 CEILING STAGE RIGHT CENTERLINE SECTION
Scale: 3/4\" = 1'-0"

1 REFLECTED CEILING PLAN
Scale: 3/4\" = 1'-0"

11 CEILING STAGE LEFT CENTERLINE SECTION
Scale: 3/4\" = 1'-0"

12 CEILING COMPOSITE FRONT ELEVATION
Scale: 3/4\" = 1'-0"

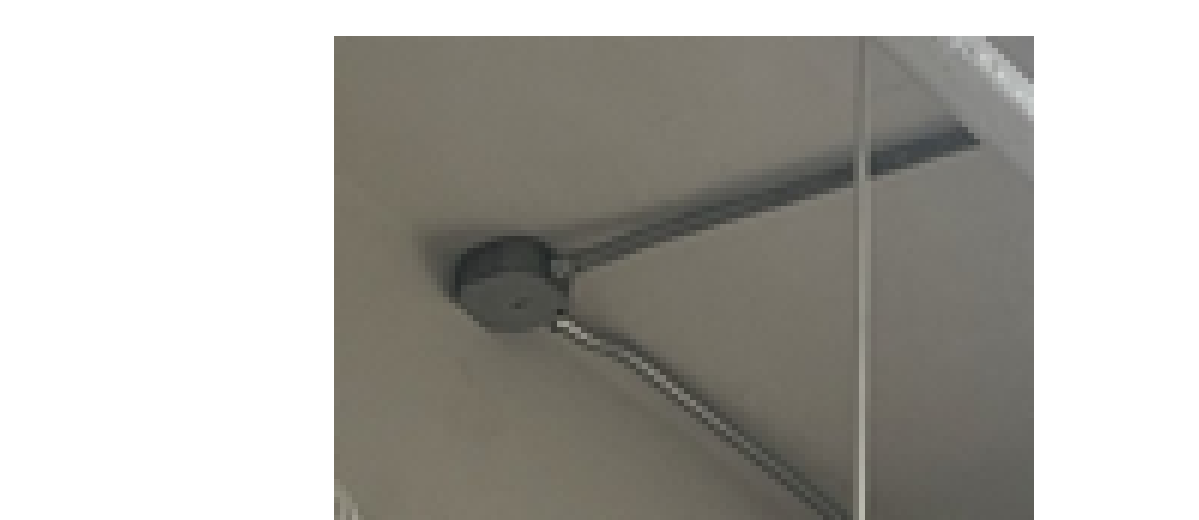

5 04 BULB MOUNT CONDUIT PIPE & BOX RESEARCH IMAGE NOT TO SCALE



6 04 BULB MOUNT REFERENCE NOT TO SCALE

HOME DEPOT 660 WAT MEDIUM BASE SINGLE CIRCUIT CEILING MOUNT GLAZED PORCELAIN INCANDESCENT LAMPHOLDER, WHITE

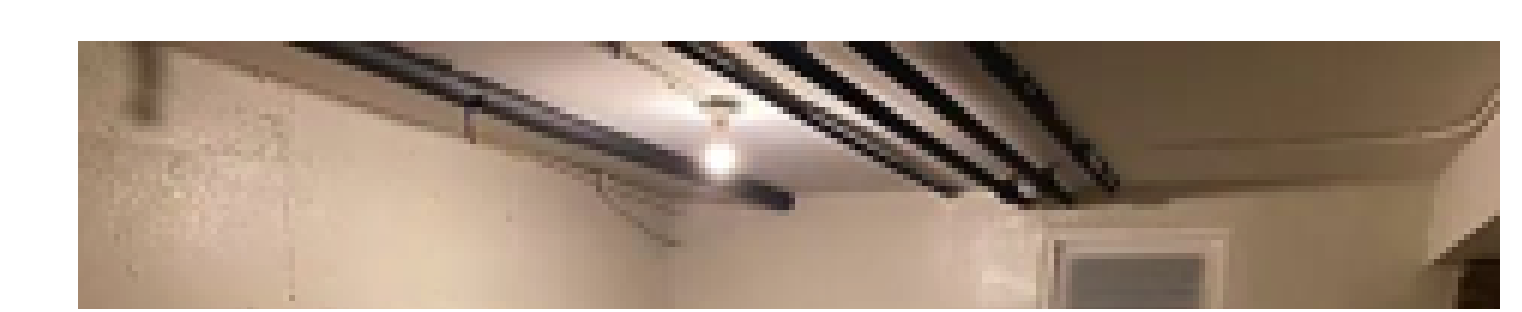

7 04 PIPES & PIPE SUPPORTS RESEARCH NOT TO SCALE



8 04 PIPES & PIPE SUPPORTS RESEARCH NOT TO SCALE

DISCLAIMER

THIS DRAWING REPRESENTS VISUAL CONCEPTS AND SUGGESTIONS FOR CONSTRUCTION ONLY. THE DESIGNER IS UNQUALIFIED TO DETERMINE THE ELECTRICAL OR STRUCTURAL APPROPRIATENESS OF THIS DESIGN AND WILL NOT ASSUME RESPONSIBILITY FOR IMPROPER ENGINEERING, CONSTRUCTION, OR USE.

REVISIONS

#	REVISION	DATE
5	REVISION	12/07/2022
4	REVISION	12/05/2022
3	REVISION	12/02/2022
2	FINAL	11/18/2022
1	PRELIM.	10/20/2022

NOTES

- WALLS A AND B ARE WAGONS: WALLS C, D, AND UNIT E ARE STATIONARY AND DO NOT MOVE.
- WALLS A AND B BUILT CONNECTED TO EACH OTHER, REFERRED TO AS "UNIT A/B". SEE PLATE 4 FOR DETAILS
- PLEASE NOTE: THE SCRIPT CALLS FOR AN ACTOR TO BEAT A BASEBALL BAT A REPEATED NUMBER OF TIMES AGAINST THE FLOOR AND WALLS OF THE SET.
- NO SEAMS VISIBLE IN WALLS
- SEE PLATE 08 FOR PAINT DETAILS
- PLEASE NOTE THE 1/2" GAP BETWEEN BOTTOM OF ALL WAGON FLATS AND THE THEATRE FLOOR. WALLS C, D, H, J AND UNIT E DO NOT HAVE THESE GAPS

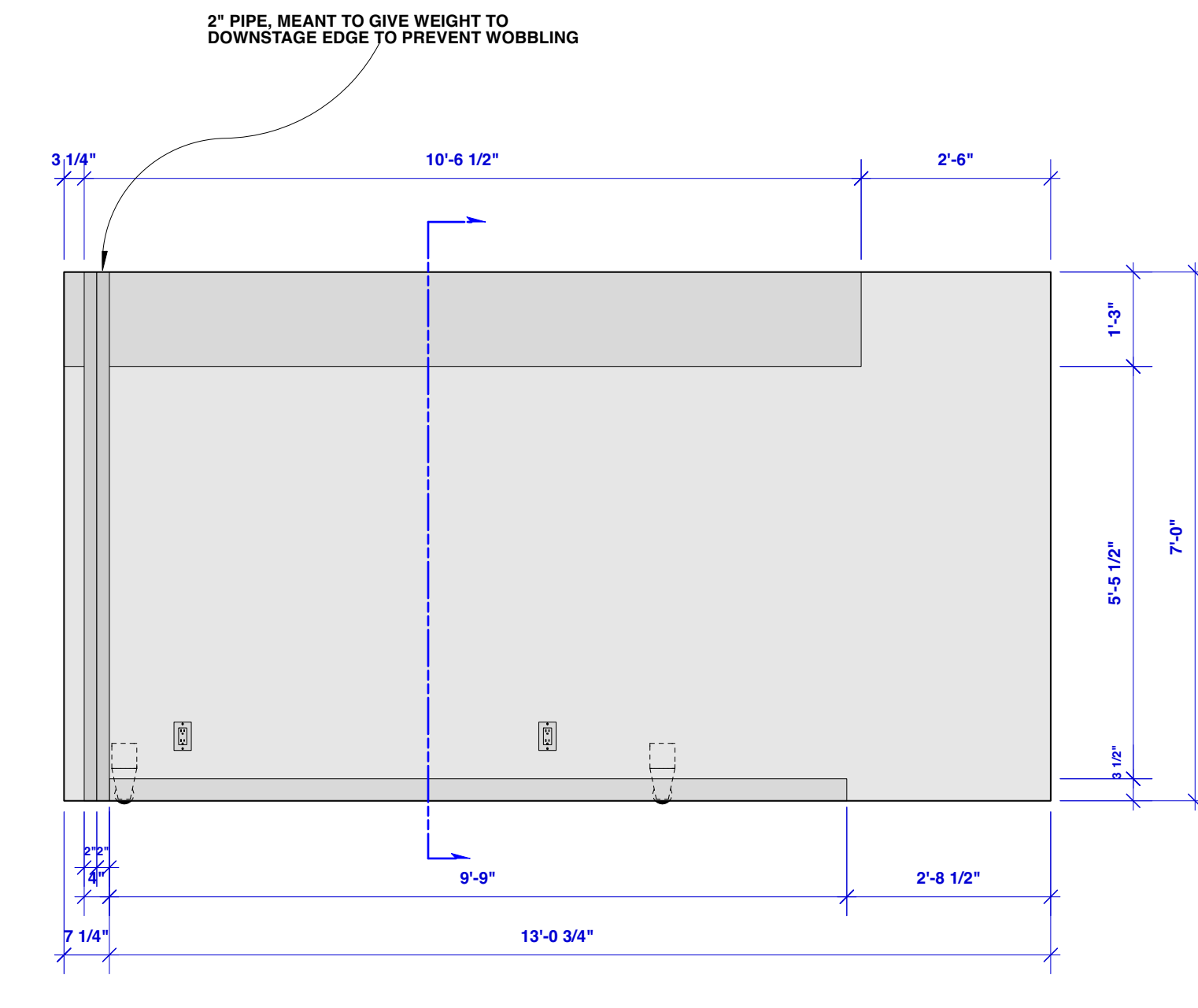

1 WALL A ELEVATION
Scale: 1/2" = 1'-0"

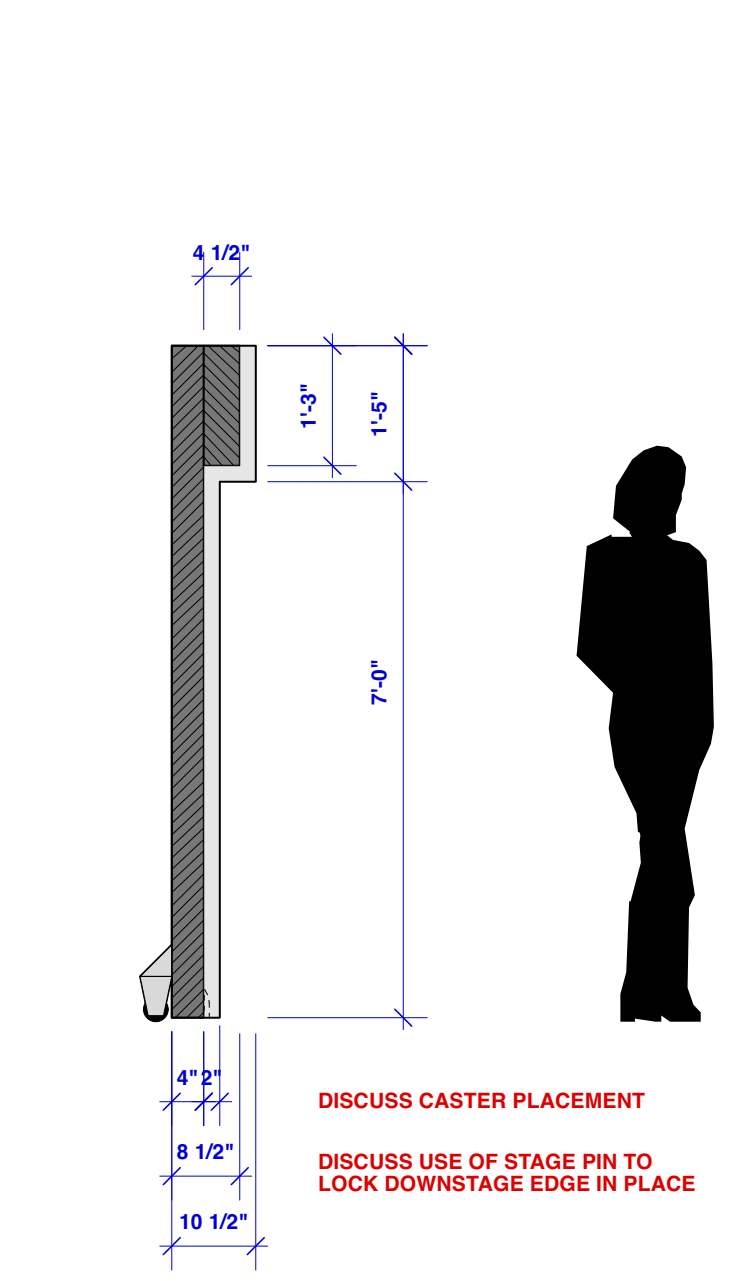

3 WALL A SECTION
Scale: 1/2" = 1'-0"

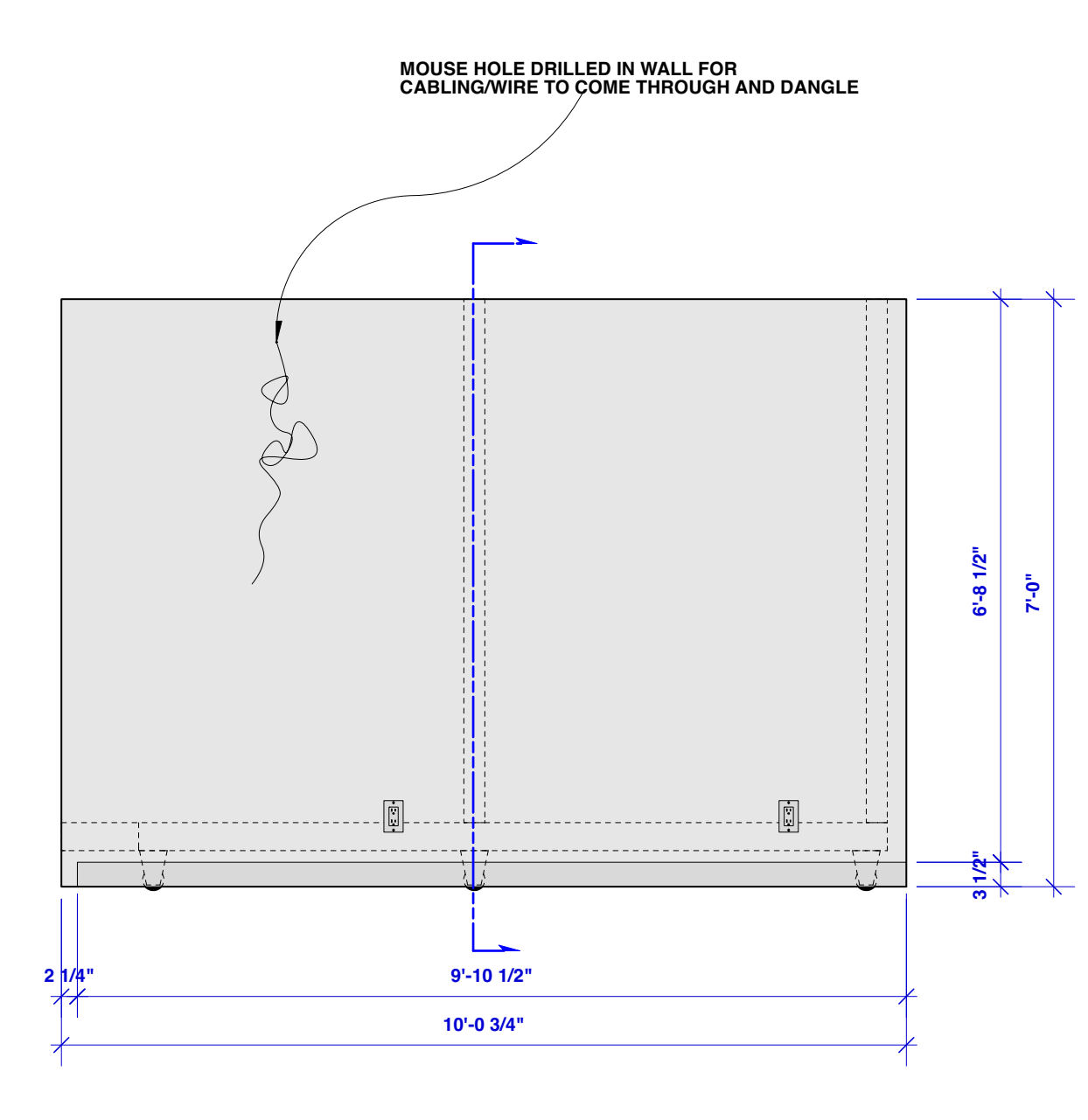

4 WALL B ELEVATION
Scale: 1/2" = 1'-0"

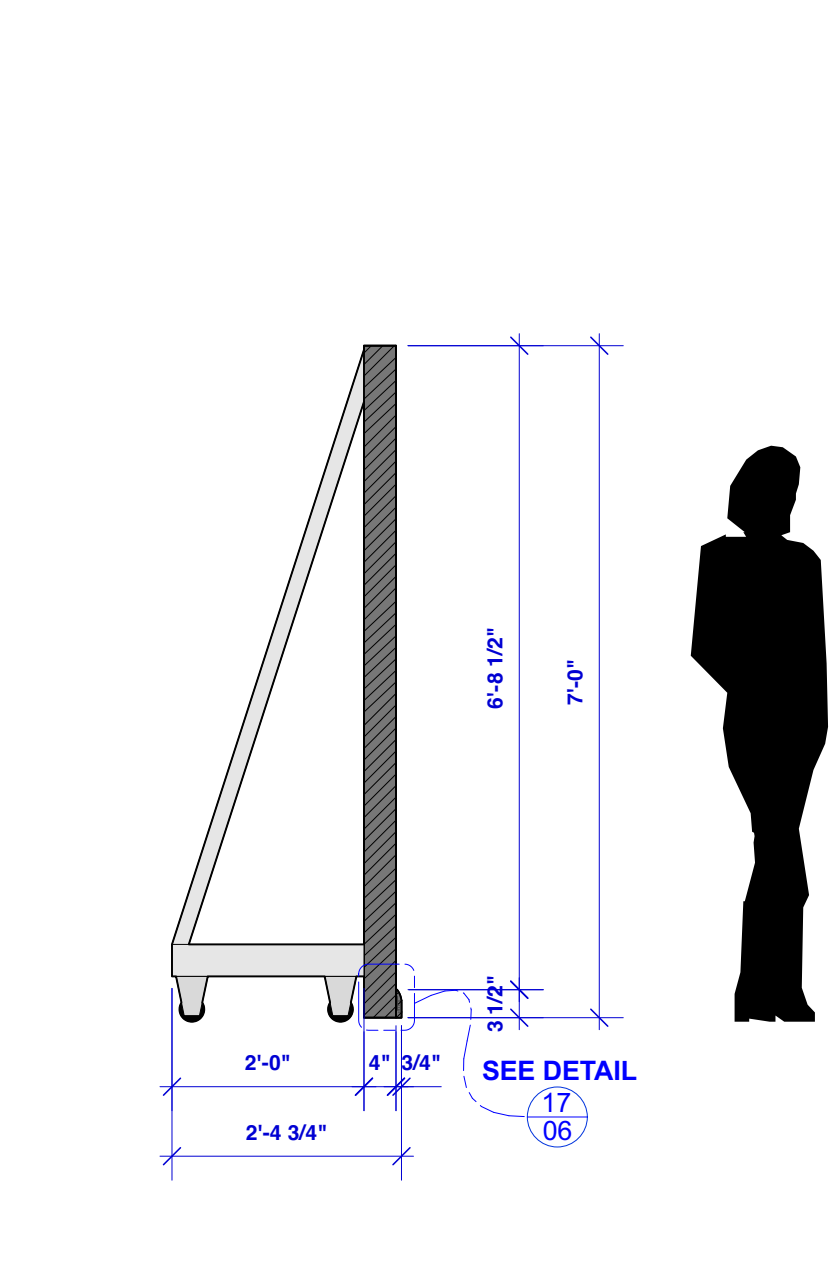

6 WALL B SECTION
Scale: 1/2" = 1'-0"

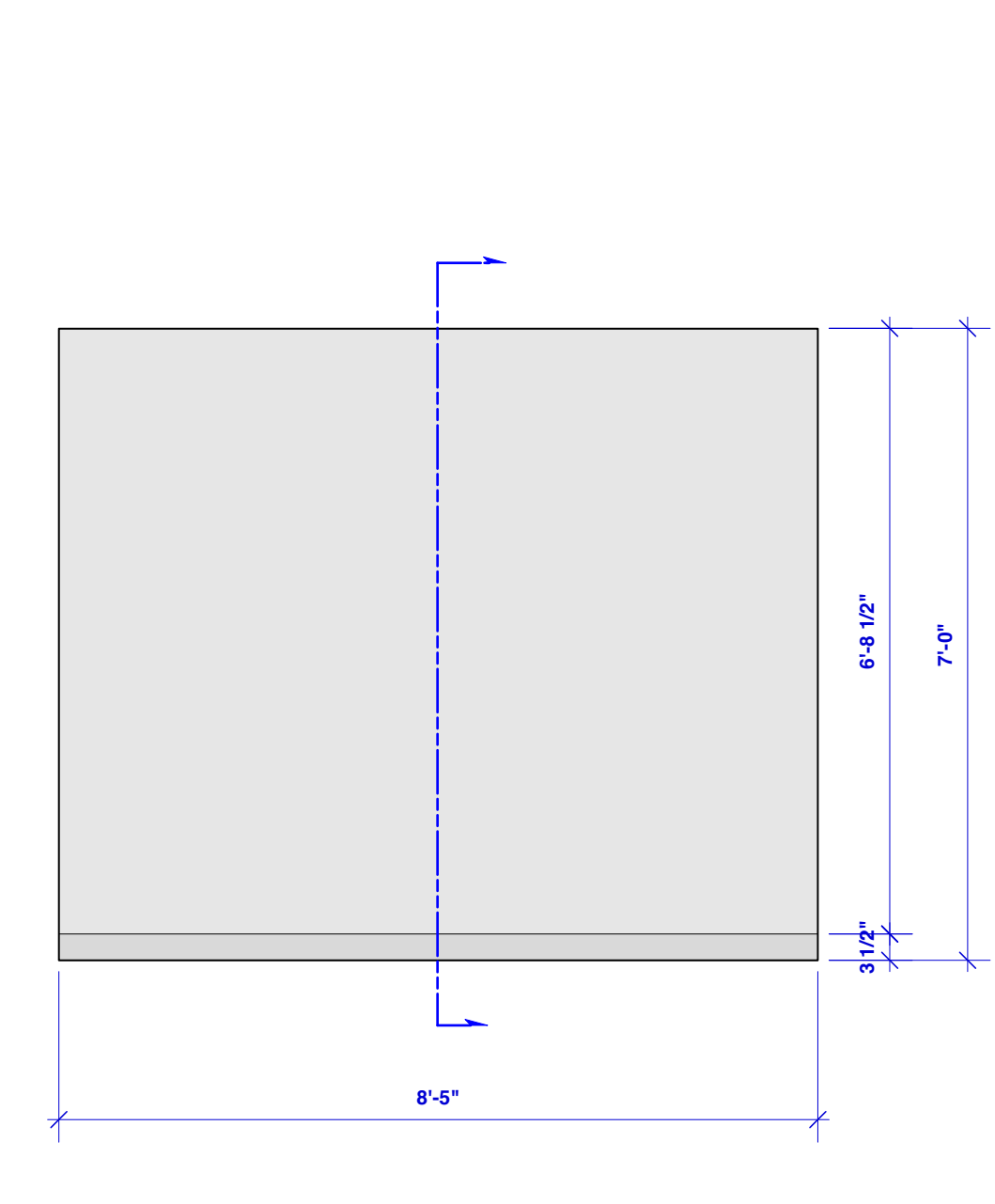

7 WALL C ELEVATION
Scale: 1/2" = 1'-0"

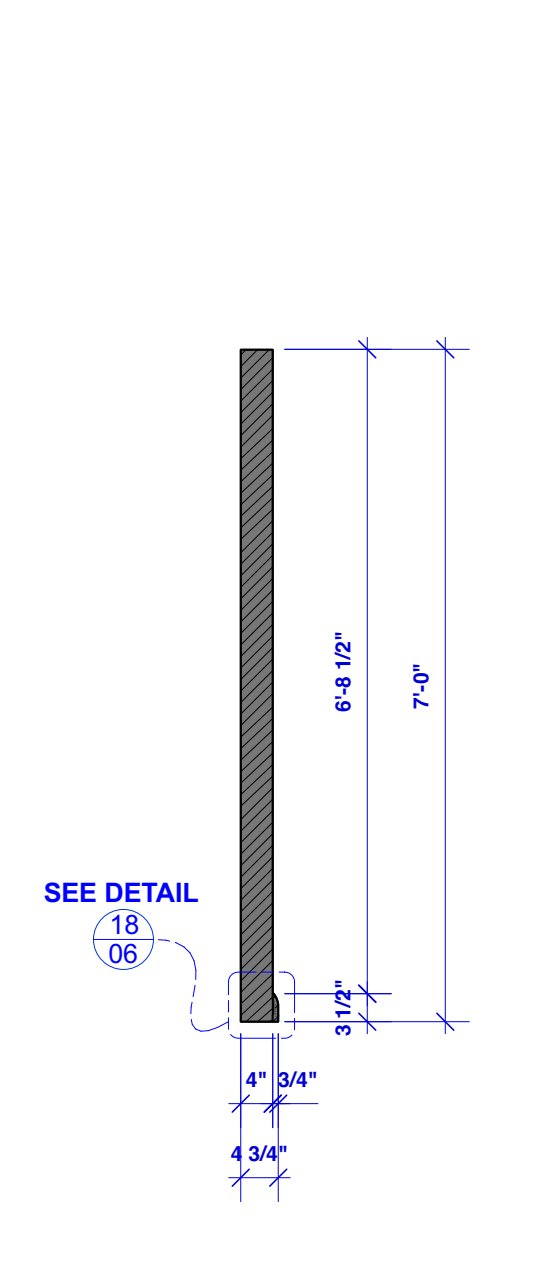

9 WALL C SECTION
Scale: 1/2" = 1'-0"

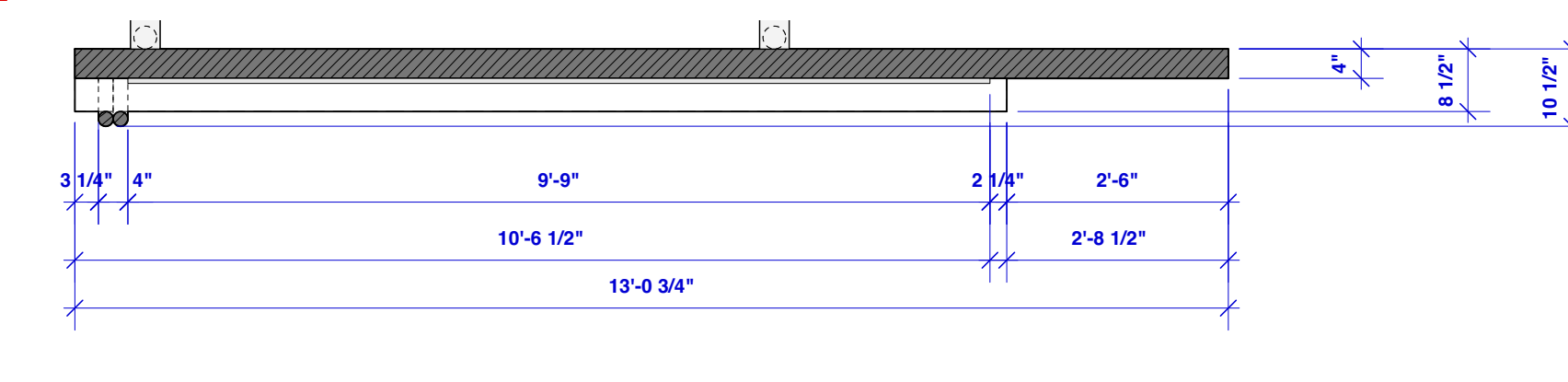

2 WALL A PLAN
Scale: 1/2" = 1'-0"

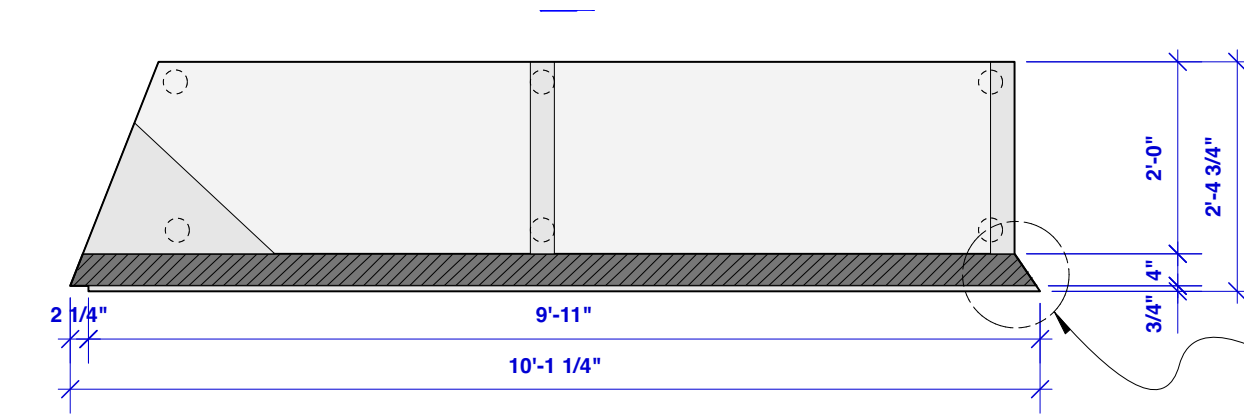

5 WALL B PLAN
Scale: 1/2" = 1'-0"

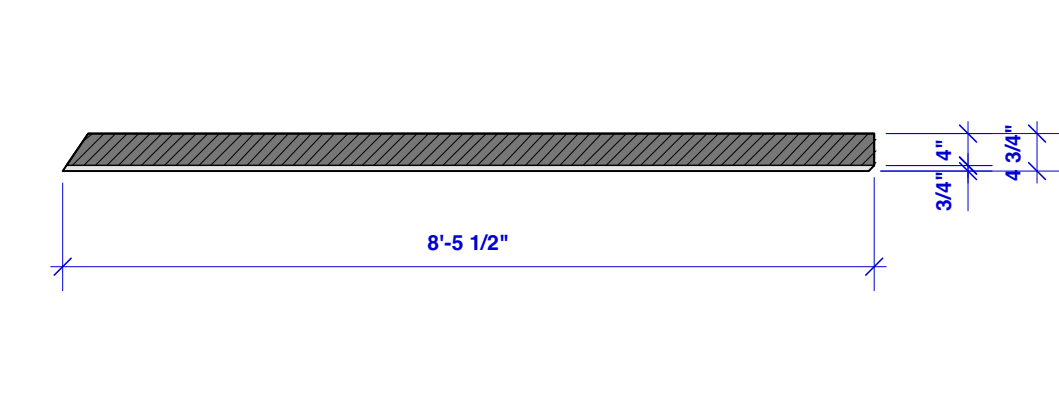

8 WALL C PLAN
Scale: 1/2" = 1'-0"

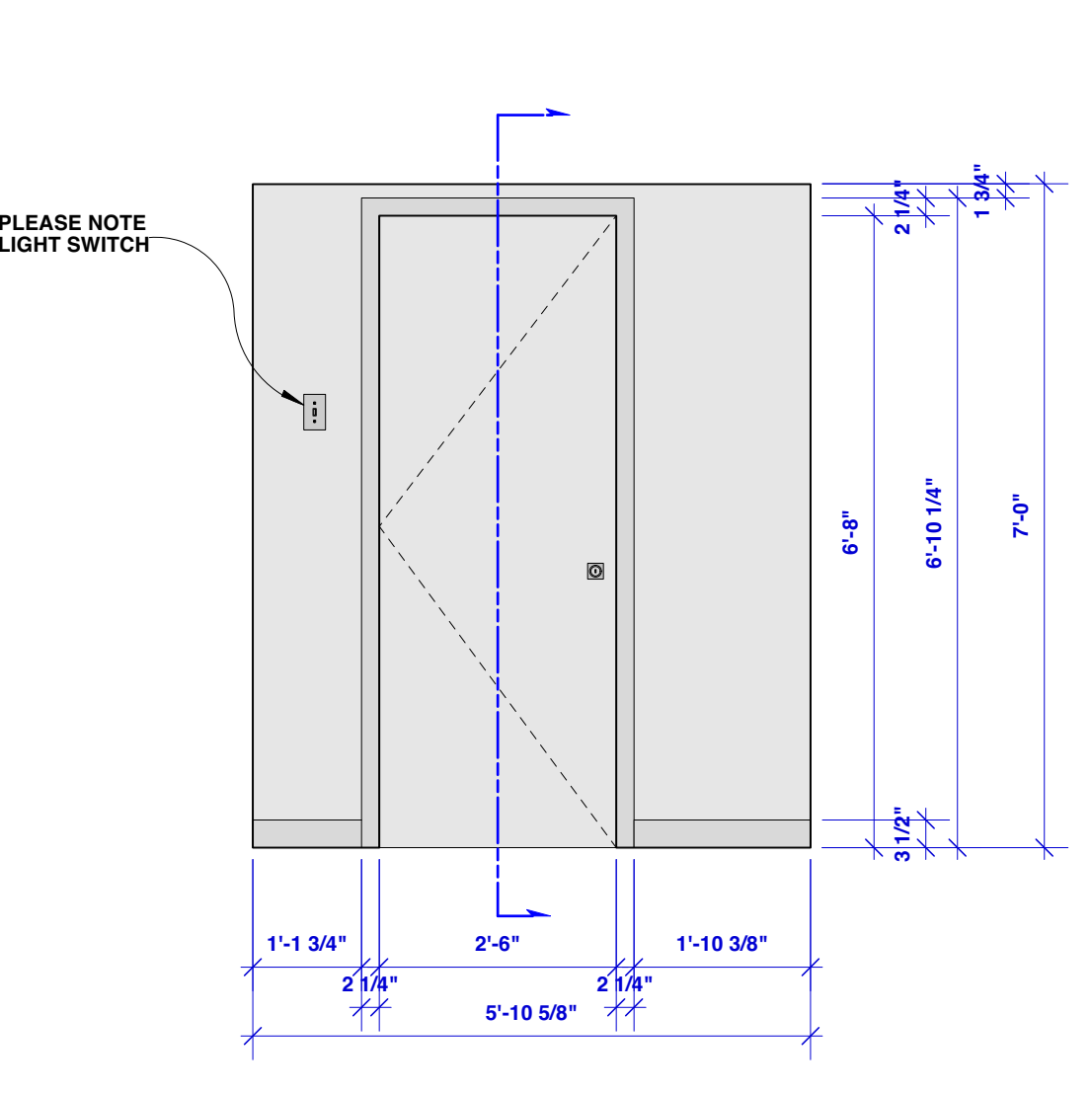

10 WALL D ELEVATION
Scale: 1/2" = 1'-0"

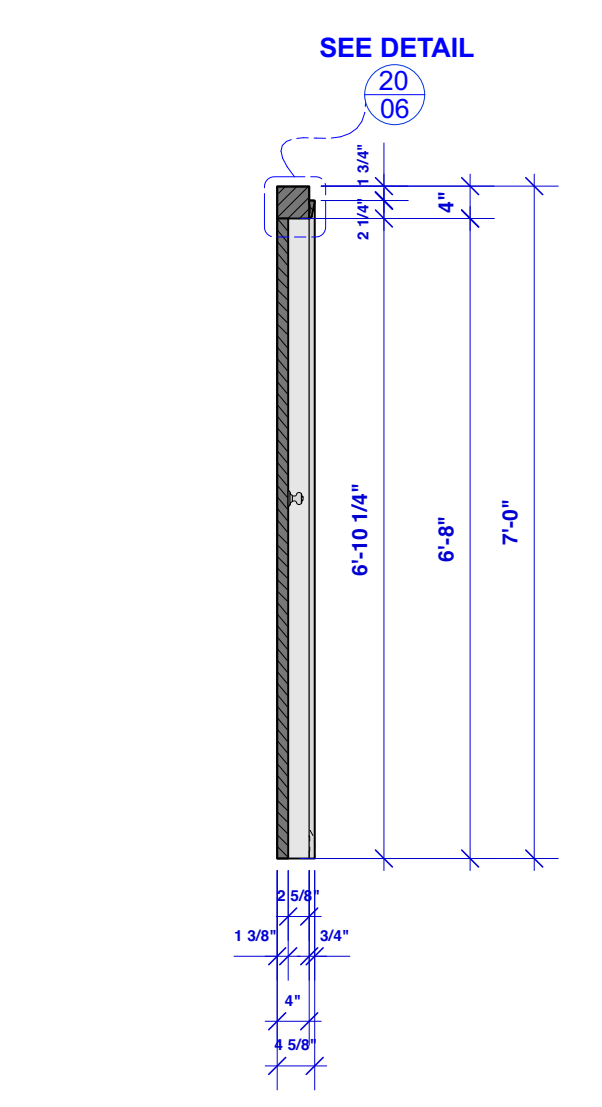

12 WALL D SECTION
Scale: 1/2" = 1'-0"

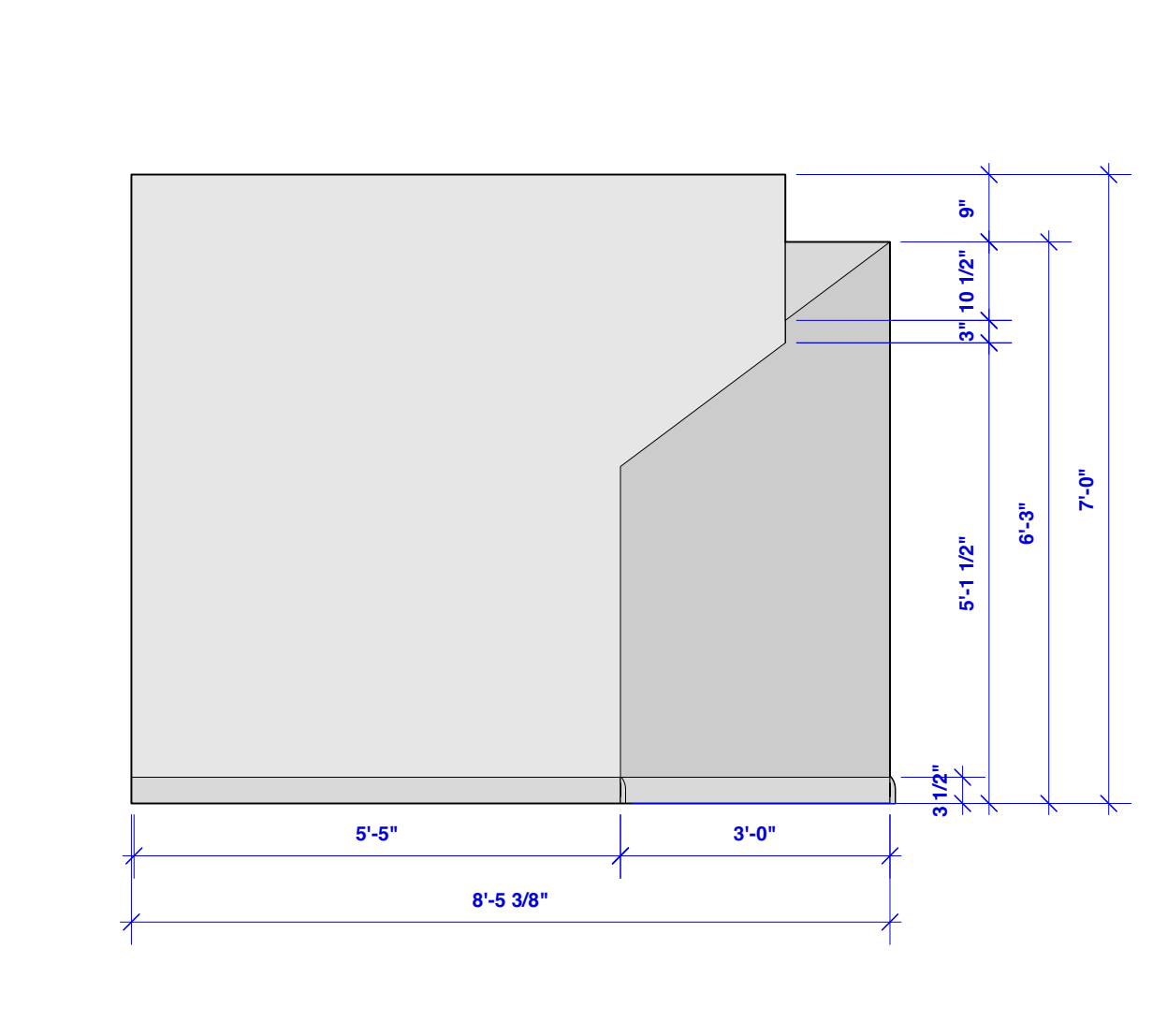

13 UNIT E STAGE LEFT ELEVATION
Scale: 1/2" = 1'-0"

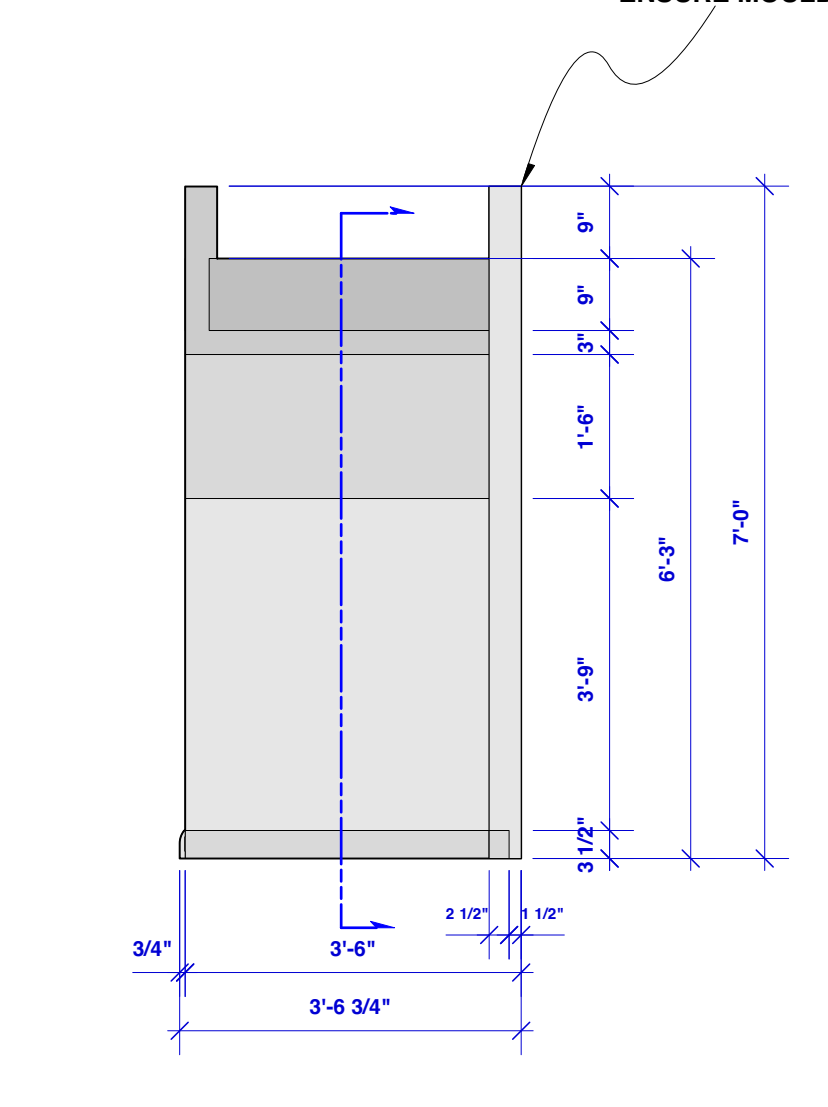

15 UNIT E FRONT ELEVATION
Scale: 1/2" = 1'-0"

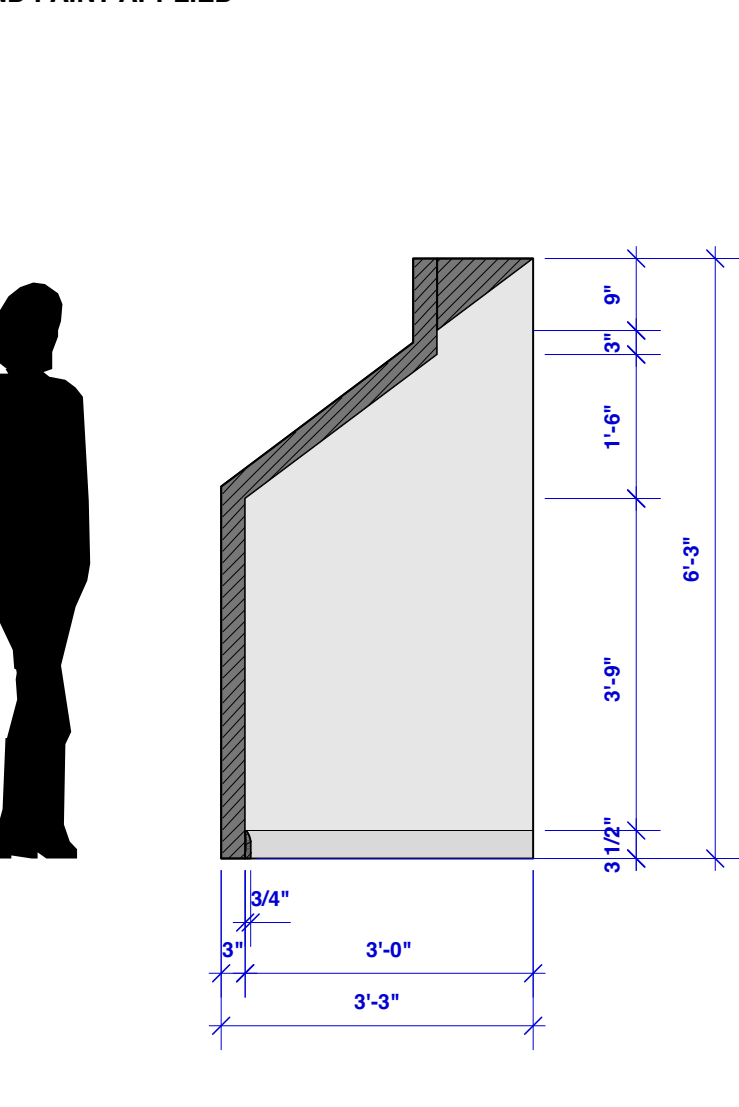

16 UNIT E SECTION
Scale: 1/2" = 1'-0"

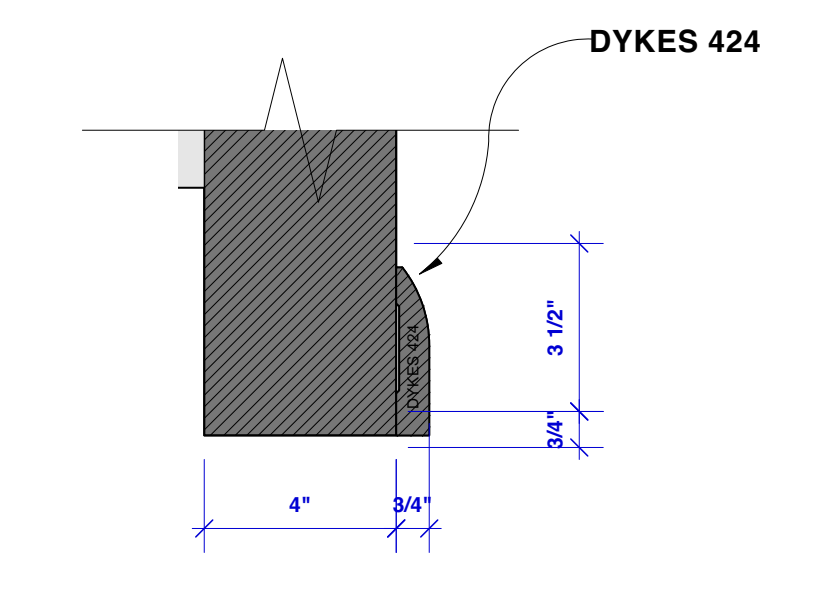

17 BASE BOARD DETAIL - WAGON WALLS
Scale: 3" = 1'-0"

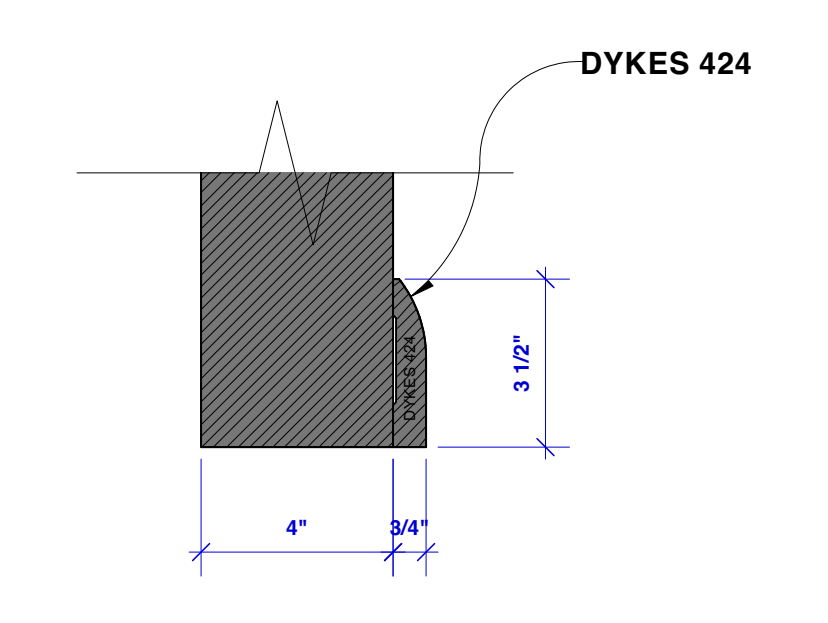

18 BASE BOARD DETAIL - STATIONARY WALLS
Scale: 3" = 1'-0"

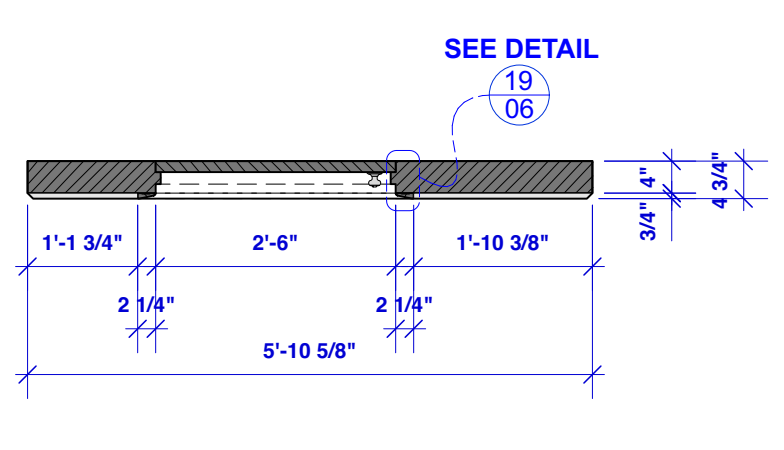

11 WALL D PLAN
Scale: 1/2" = 1'-0"

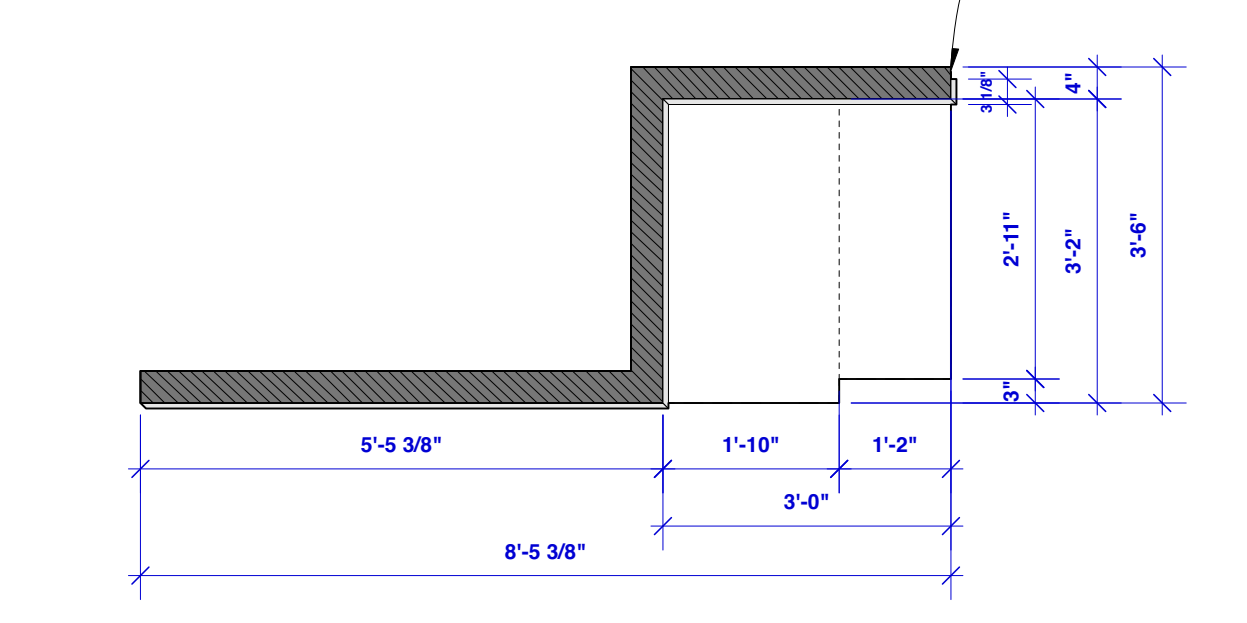

14 UNIT E PLAN
Scale: 1/2" = 1'-0"

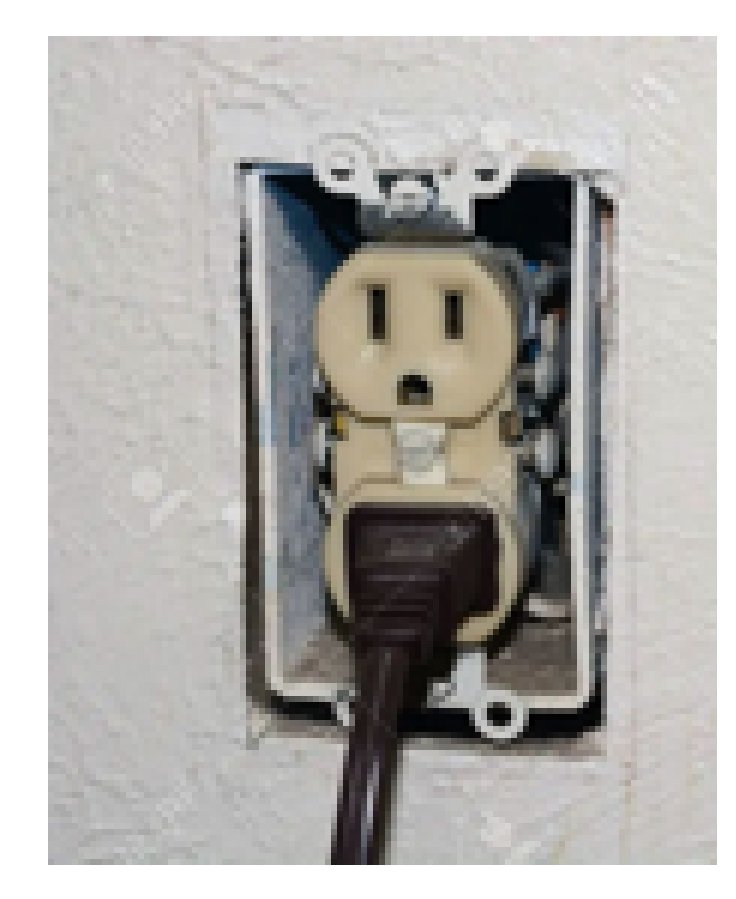

21 OUTLET RESEARCH IMAGE
NOT TO SCALE
PLEASE INSTALL MOST OUTLETS WITHOUT COVER. THE SPACE SHOULD FEEL ELECTRICALLY HAPHAZARD



22 DOOR REFERENCE
NOT TO SCALE
HOME DEPOT 30" x 80" NO PANEL UNFINISHED HARDWOOD SINGLE PREHUNG INTERIOR DOOR ROUND DOORKNOB - PLEASE HAVE UPSTAGE DOORKNOB INCLUDE LOCK AS SHOWN IN REFERENCE IMAGE

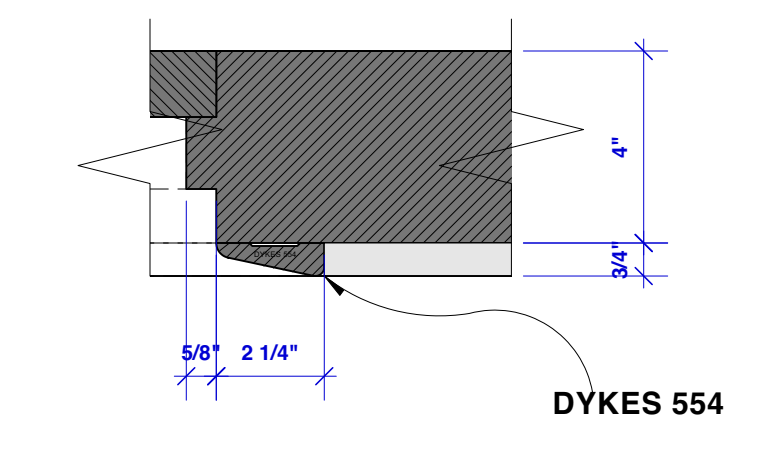

19 DOOR CASING DETAIL - PLAN
Scale: 3" = 1'-0"

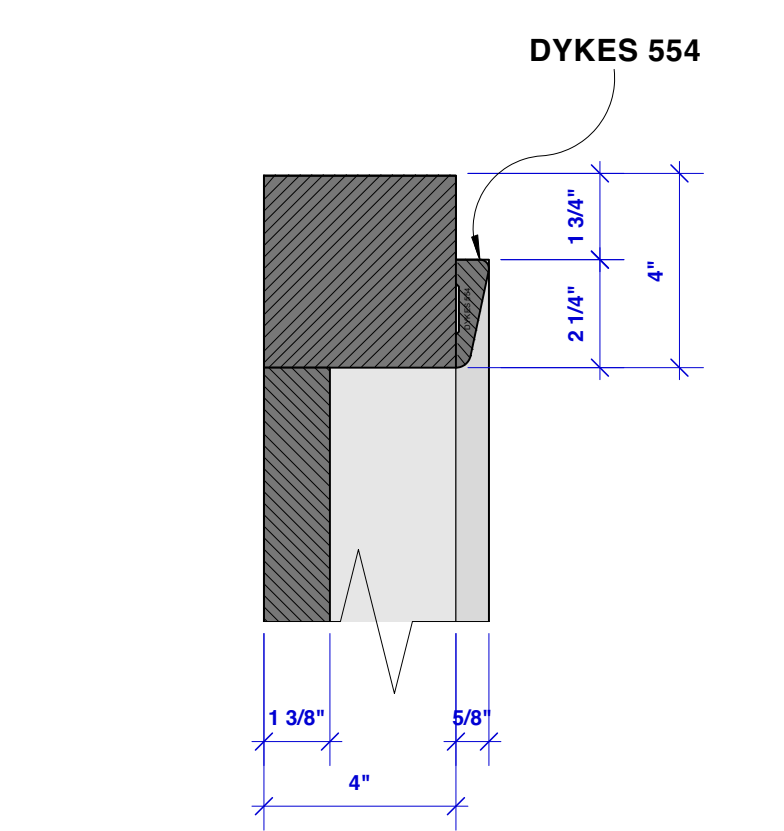

20 DOOR CASING DETAIL - SECTION
Scale: 3" = 1'-0"

PLEASE NOTE THE 1/2" GAP BETWEEN BOTTOM OF ALL WAGON FLATS AND THEATRE FLOOR.
WALLS C, D, H, J, AND UNIT E DO NOT HAVE THESE GAPS.
SEE PLATE 04 FOR FURTHER DETAIL ON HOW WALLS MEET DECK & THEATRE FLOOR.

QUEENS

WRITTEN BY MARTYNA MAJOK

DIRECTED BY TEA ALAGIC
SCENIC DESIGN BY TAYLOR FRIEL
TECHNICAL DIRECTION BY JON ALLAIRE
ASSISTANT TECHNICAL DIRECTOR:
AARON MINERBROOK
ASSISTANT SCENIC DESIGNERS:
VINITA GATNE & BRIAN BERNHARD

VENUE:
THE ATLAS ROOM
111 SECOND AVENUE
NEW YORK, NEW YORK 10003

WALLS A, B, C, D,
AND UNIT E

DATE:
07 DECEMBER 2022

SCALE:
AS NOTED

PLATE
06
OF 09

PLEASE NOTE & PRIORITIZE:

ACTOR WILL BE CLIMBING THROUGH THE UPSTAGE SLIDING WINDOW.

BEFORE FINAL BUILD PLAN, A FULL SCALE MOCK-UP OF THE WINDOW NEEDS TO BE MADE TO ENSURE ACTOR'S COMFORT AND SAFETY.

DISCLAIMER

THIS DRAWING REPRESENTS VISUAL CONCEPTS AND SUGGESTIONS FOR CONSTRUCTION ONLY. THE DESIGNER IS UNQUALIFIED TO DETERMINE THE ELECTRICAL OR STRUCTURAL APPROPRIATENESS OF THIS DESIGN AND WILL NOT ASSUME RESPONSIBILITY FOR IMPROPER ENGINEERING, CONSTRUCTION, OR USE.

REVISIONS

#	REVISION	DATE
5	REVISION	12/07/2022
4	REVISION	12/05/2022
3	REVISION	12/02/2022
2	FINAL	11/18/2022
1	PRELIM.	10/20/2022

NOTES

- WALLS F, AND ARE WAGONS. H AND J MOVE BUT JUST HAVE JACKS
- PLEASE NOTE: THE SCRIPT CALLS FOR AN ACTOR TO BEAT A BASEBALL BAT A REPEATED NUMBER OF TIMES AGAINST THE FLOOR AND WALLS OF THE SET.
- NO SEAMS VISIBLE IN WALLS
- SEE PLATE 08 FOR PAINT DETAILS
- PLEASE NOTE THE 1/2" GAP BETWEEN BOTTOM OF ALL WAGON FLATS AND THE THEATRE FLOOR. WALLS C, D, H, J AND UNIT E DO NOT HAVE THESE GAPS

QUEENS

WRITTEN BY MARTYNA MAJOK

DIRECTED BY TEA ALAGIC
 SCENIC DESIGN BY TAYLOR FRIEL
 TECHNICAL DIRECTION BY JON ALLAIRES
 ASSISTANT TECHNICAL DIRECTOR:
 AARON MINERBROOK
 ASSISTANT SCENIC DESIGNERS:
 VINITA GATNE & BRIAN BERNHARD

VENUE:
 THE ATLAS ROOM
 111 SECOND AVENUE
 NEW YORK, NEW YORK 10003

**WALLS F, G, H, J,
 AND STOOP STAIRS**

DATE:
 07 DECEMBER 2022

SCALE:
 AS NOTED

PLATE

07
 OF 09

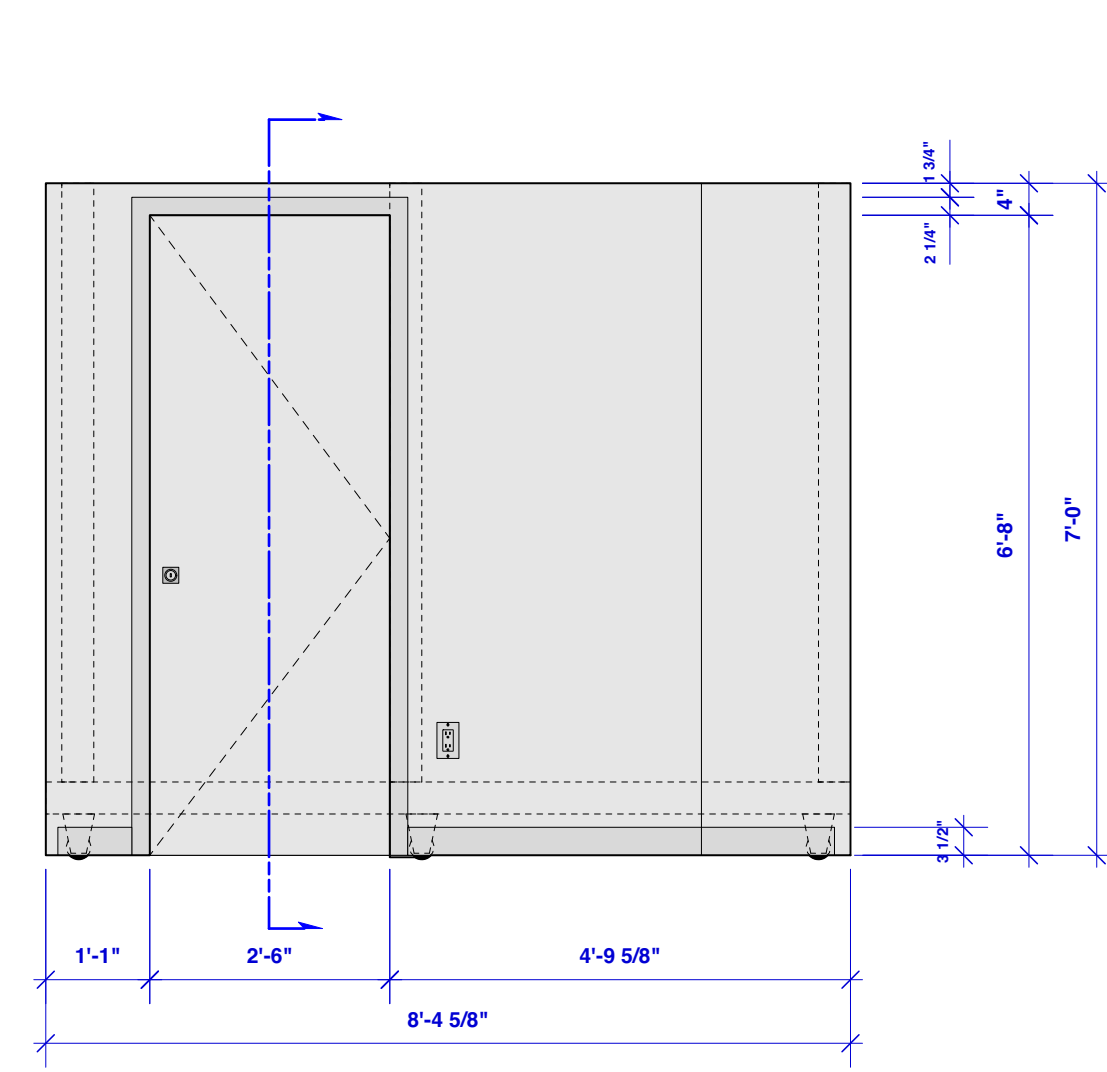

13 WALL F ELEVATION
 Scale: 1/2" = 1'-0"

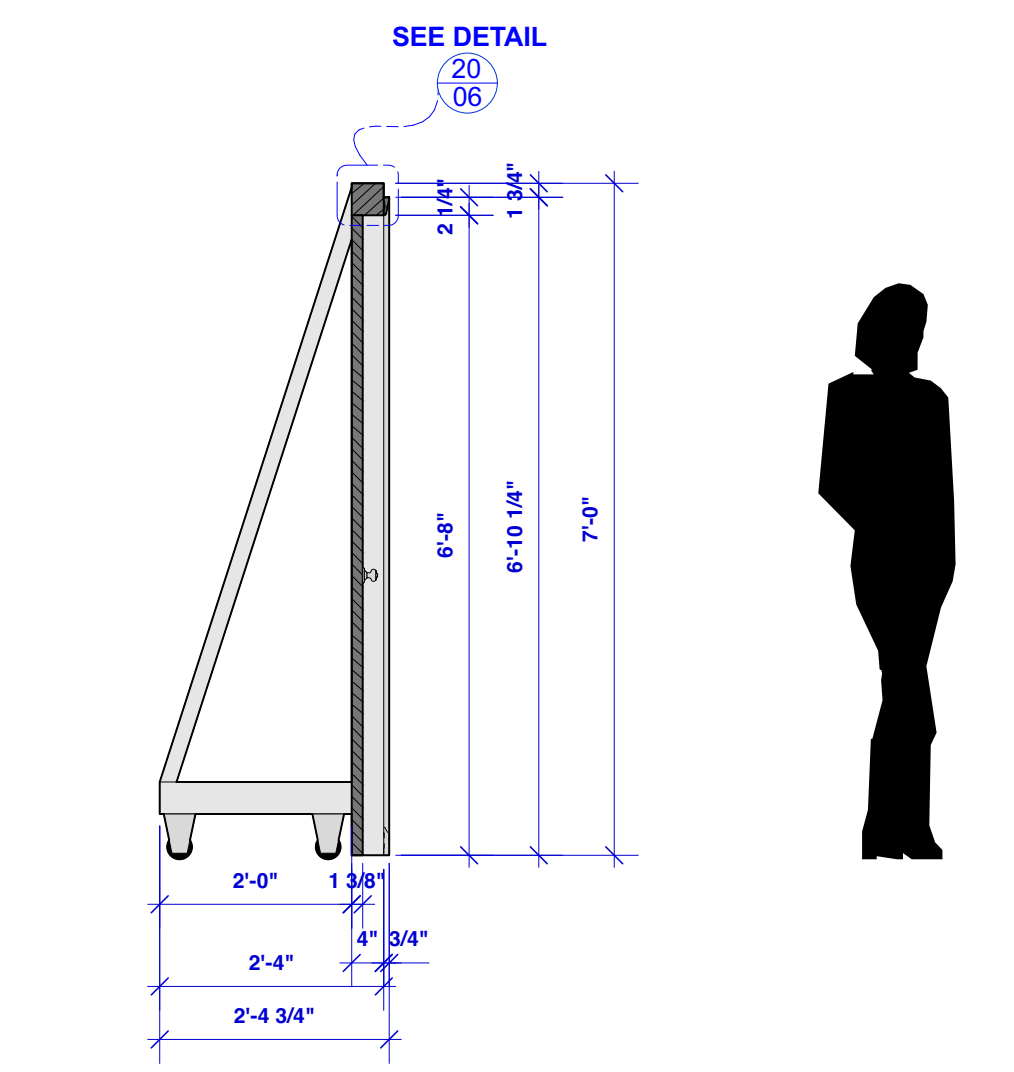

14 WALL F SECTION
 Scale: 1/2" = 1'-0"

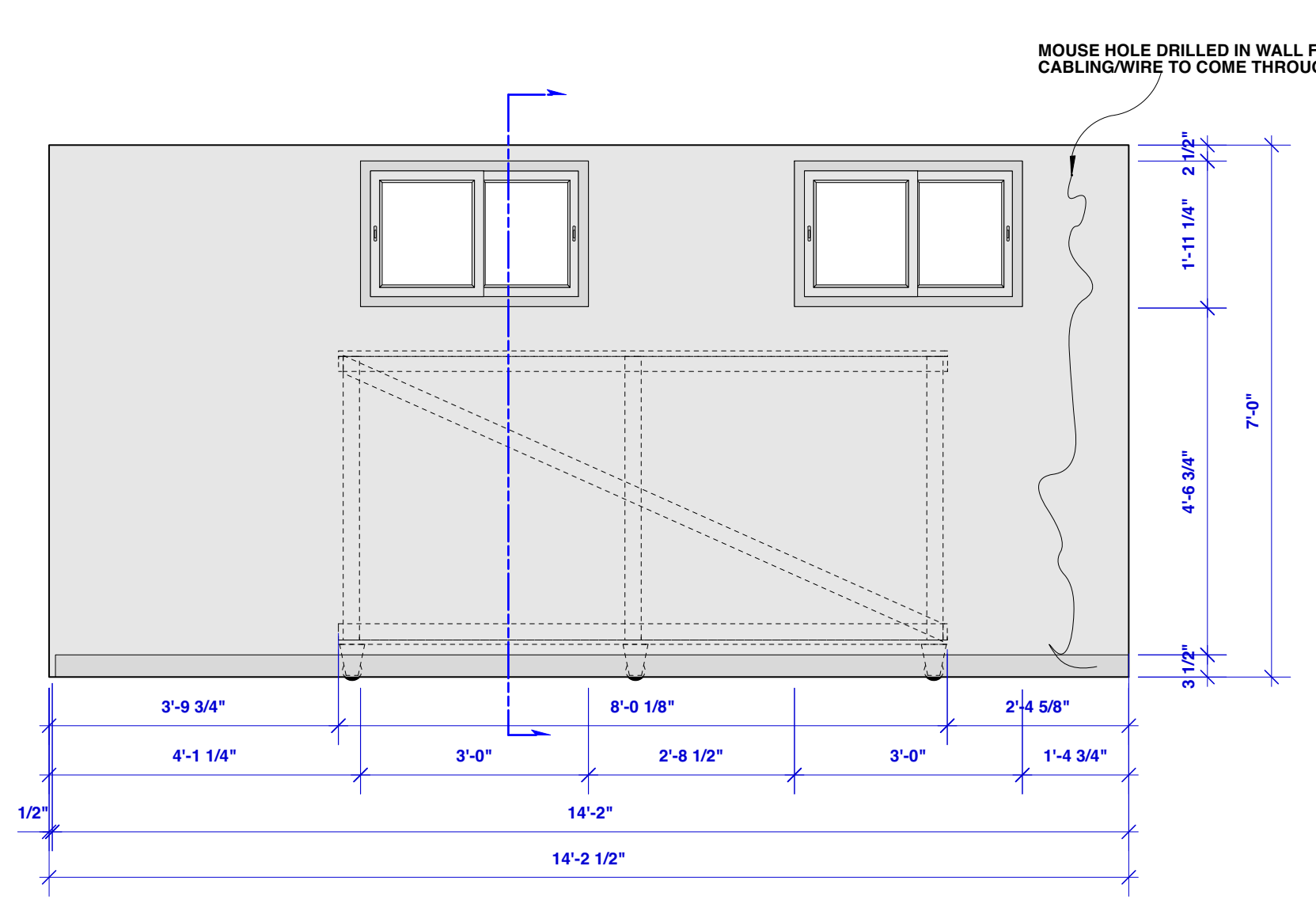

16 WALL G ELEVATION
 Scale: 1/2" = 1'-0"

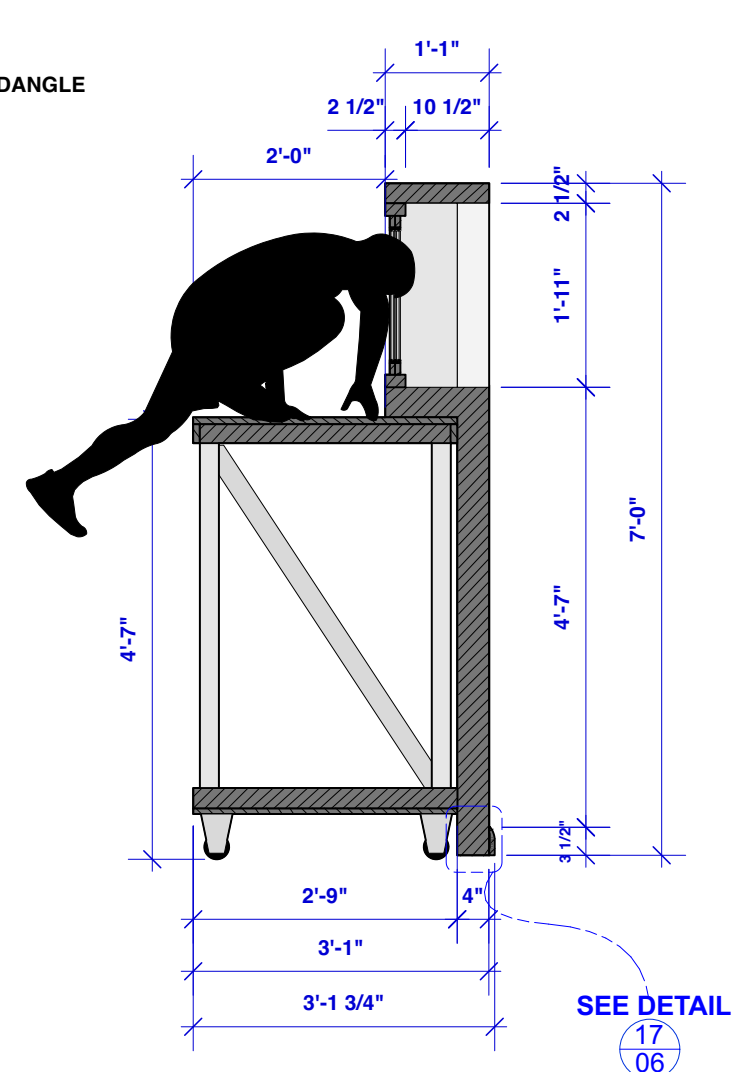

18 WALL G SECTION
 Scale: 1/2" = 1'-0"

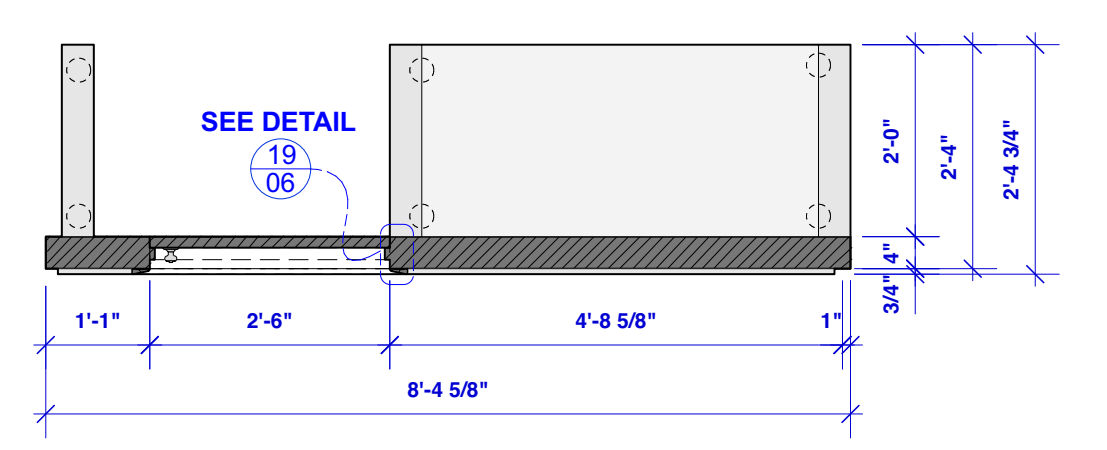

15 WALL F PLAN
 Scale: 1/2" = 1'-0"

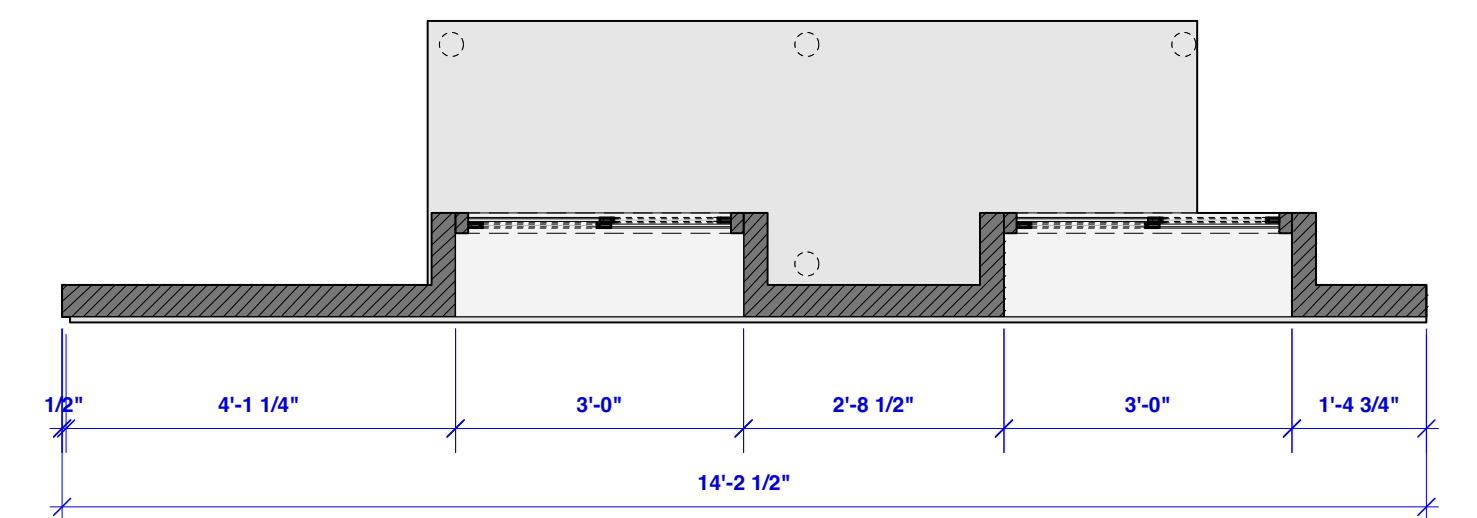

17 WALL G PLAN
 Scale: 1/2" = 1'-0"

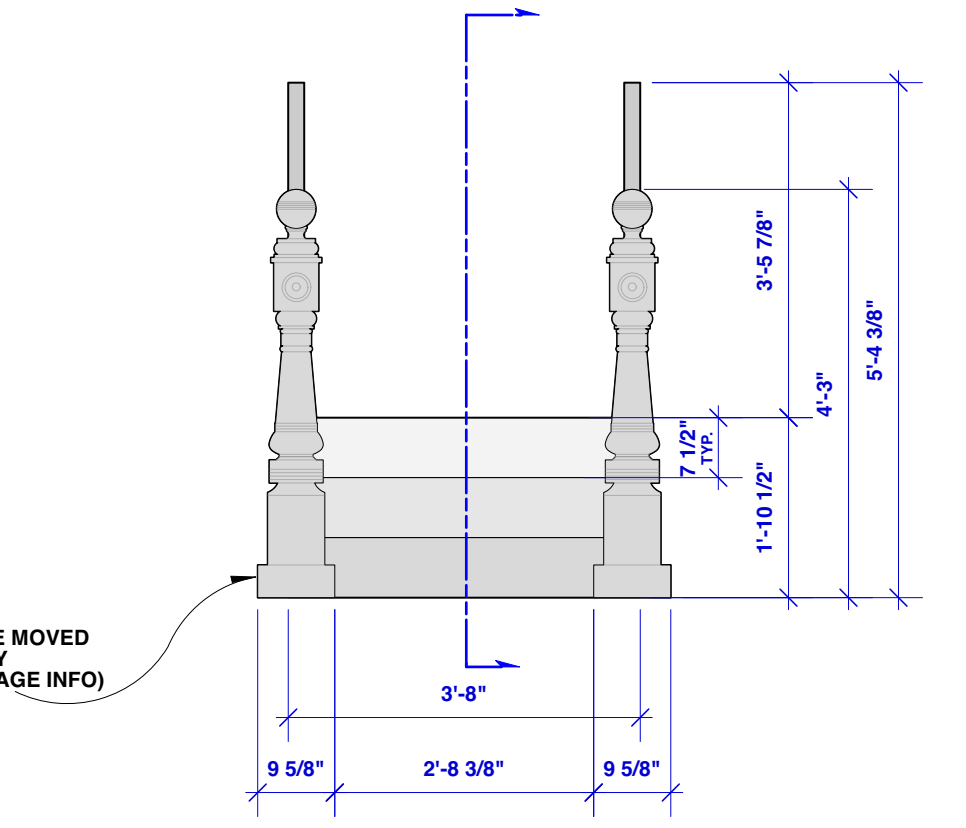

6 STOOP STAIRCASE FRONT ELEVATION
 Scale: 1/2" = 1'-0"

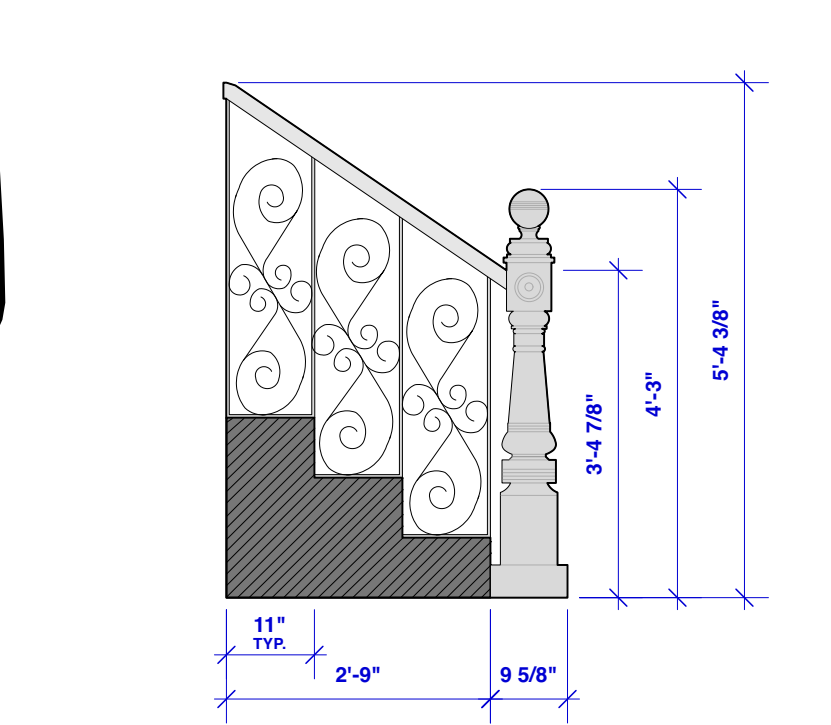

7 STOOP STAIRCASE - SECTION
 Scale: 1/2" = 1'-0"

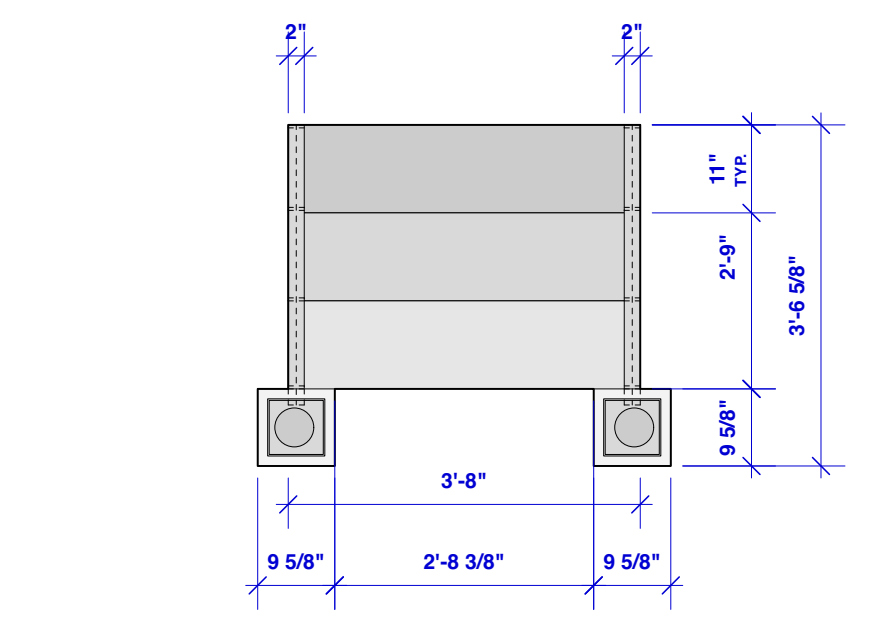

8 STOOP STAIRCASE - PLAN
 Scale: 1/2" = 1'-0"



17 STOOP RESEARCH IMAGE - SIDE PROFILE
 NOT TO SCALE

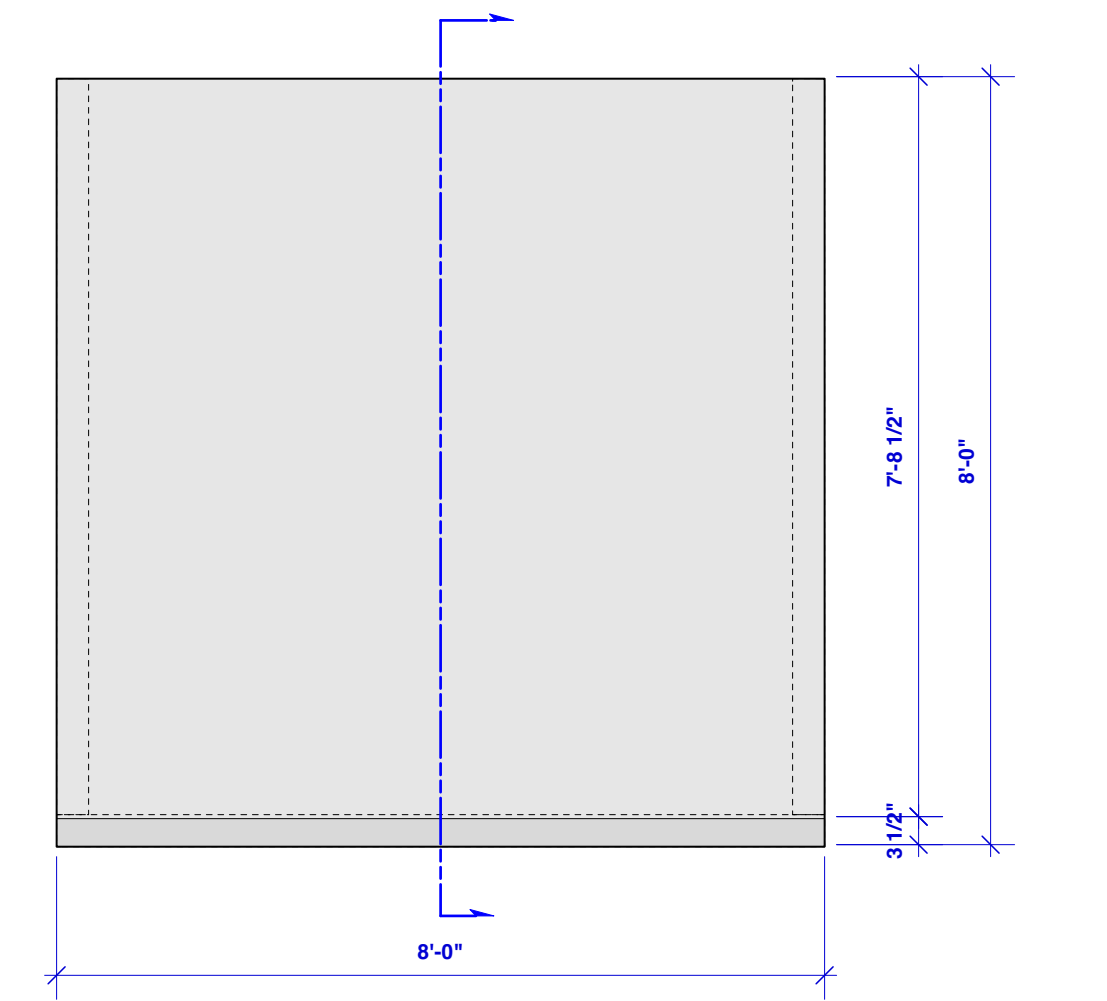

19 WALL H ELEVATION
 Scale: 1/2" = 1'-0"

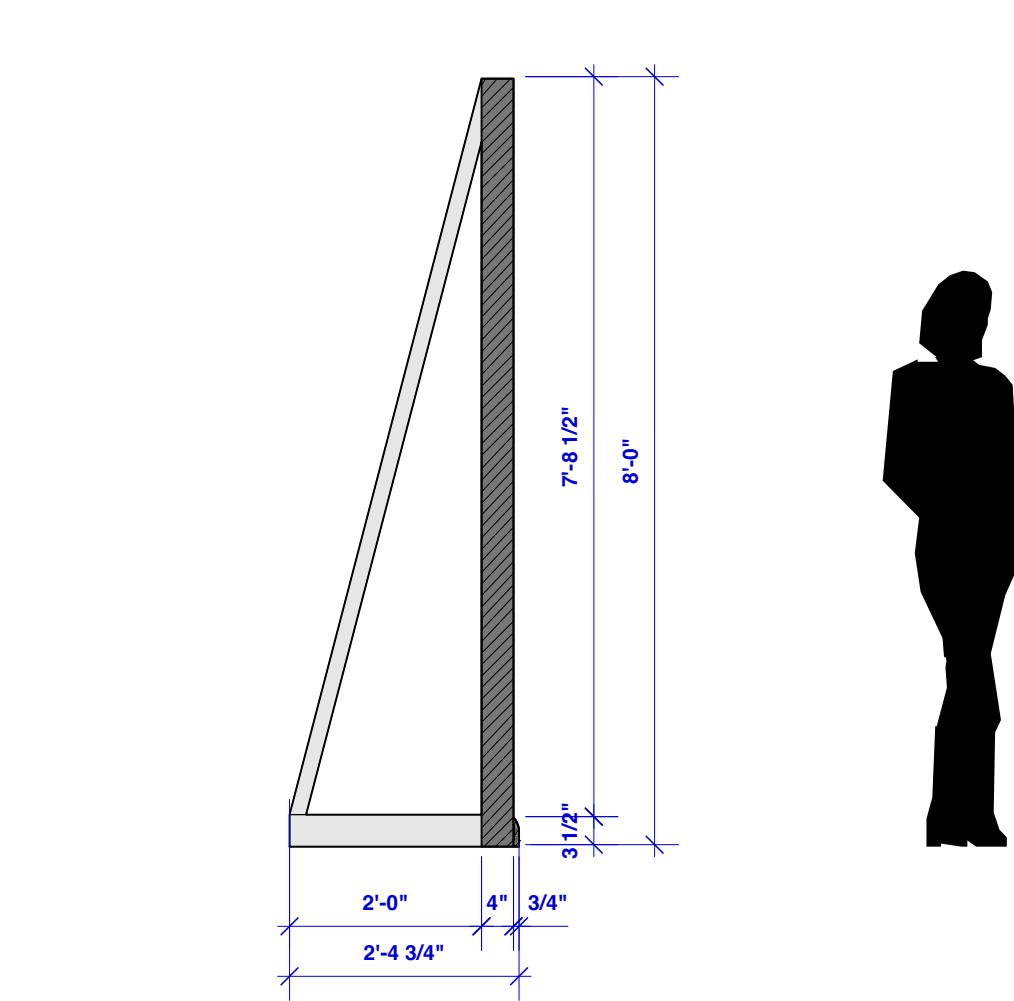

21 WALL H SECTION
 Scale: 1/2" = 1'-0"

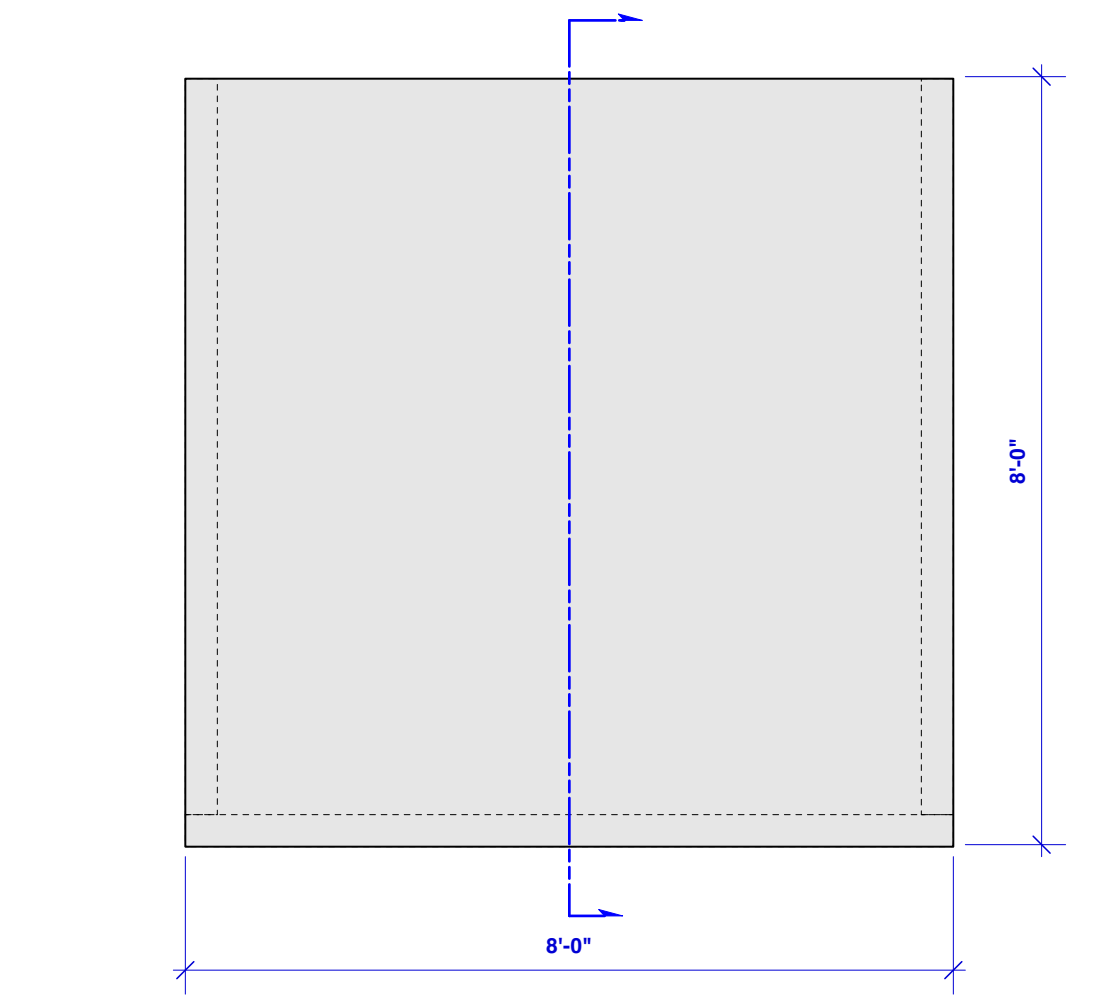

22 WALL J ELEVATION
 Scale: 1/2" = 1'-0"

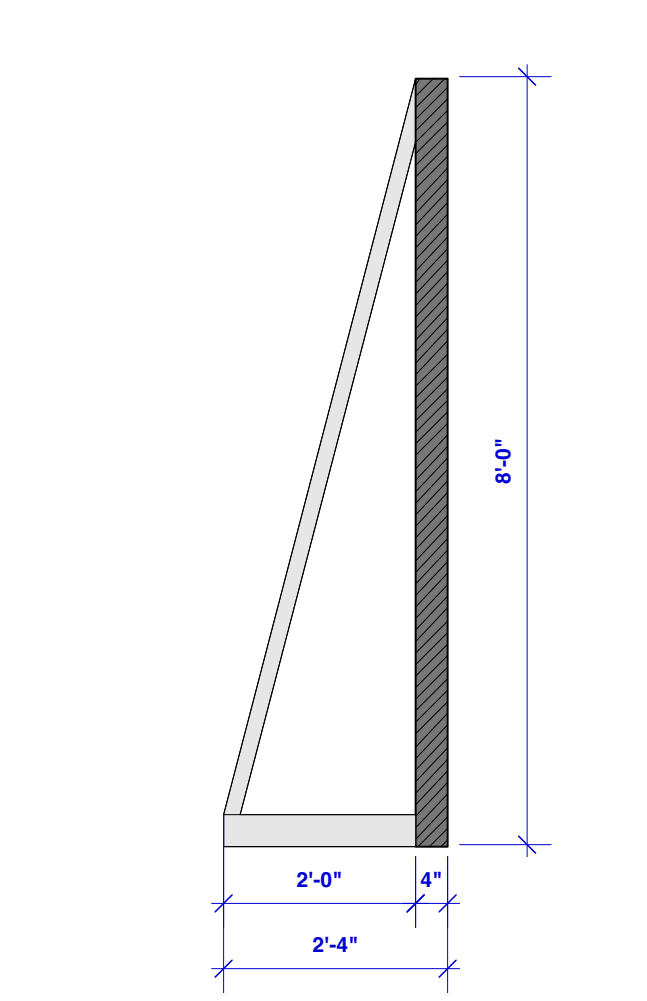

23 WALL J SECTION
 Scale: 1/2" = 1'-0"



18 STOOP RESEARCH IMAGE - FRONT ELEVATION
 NOT TO SCALE



19 STOOP RESEARCH IMAGE - NEWEL POST TOP DETAIL
 NOT TO SCALE

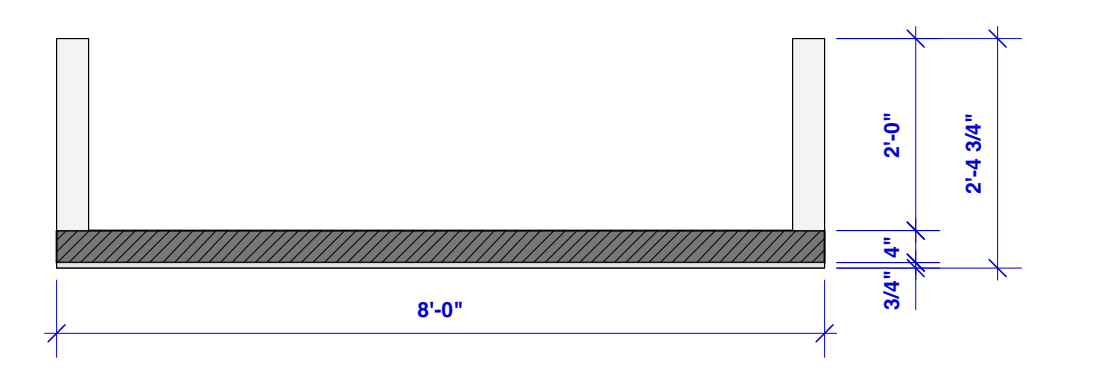

20 WALL H PLAN
 Scale: 1/2" = 1'-0"

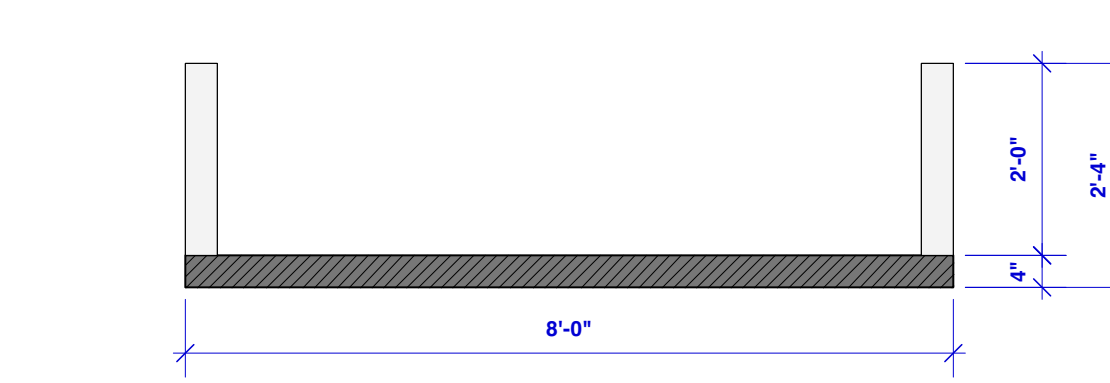

24 WALL J PLAN
 Scale: 1/2" = 1'-0"

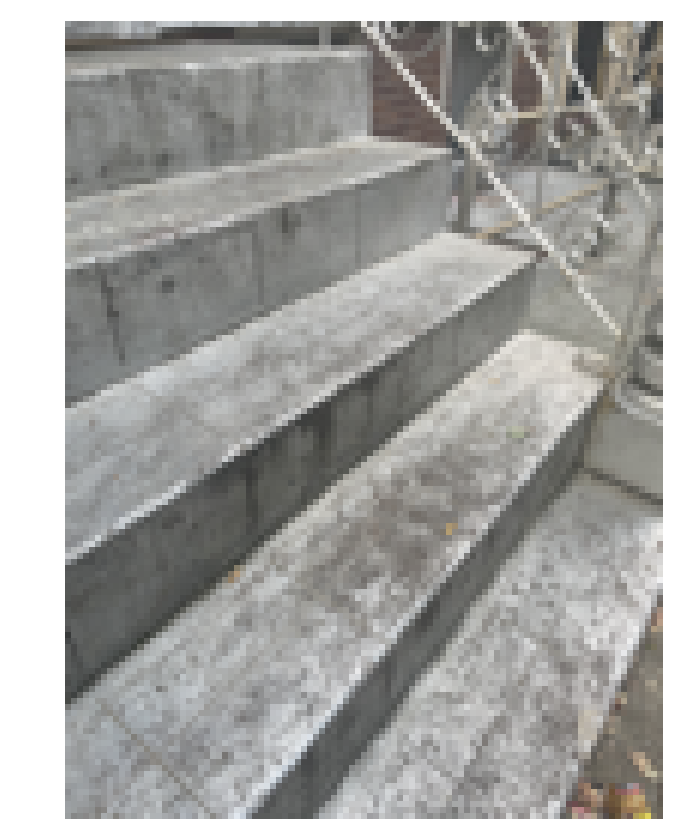

20 STOOP RESEARCH IMAGE - STEPS DETAIL
 NOT TO SCALE



22 STOOP RESEARCH IMAGE - RAILING DETAIL
 NOT TO SCALE



21 STOOP RESEARCH IMAGE - NEWEL POST BODY DETAIL
 NOT TO SCALE

**PLEASE NOTE THE 1/2" GAP BETWEEN BOTTOM OF ALL WAGON FLATS AND THEATER FLOOR.
 WALLS C, D, H, J, AND UNIT E DO NOT HAVE THESE GAPS.
 SEE PLATE 04 FOR FURTHER DETAIL ON HOW WALLS MEET DECK & THEATER FLOOR.**